

Dog control Public Space Protection Order Summary Report 2020

Introduction

From 17 July to 18 August 2020 Wyre Council undertook a review of the public space protection orders (PSPO) for dog control, across the borough, with its residents and stakeholders.

The consultation for Wyre's Public Spaces Protection Orders is based on:

- the level of support for the current dog control order measures and to gain feedback on specific aspects of these measures
- the level of support for the initiation of additional measures
- the statutory requirement to review PSPO's every three years. The current orders were agreed in 2017.

Lancashire County Council requested that additional consultation with regards to Fleetwood Nature Reserve, land owned by the County Council, be conducted. This results report will present the overall findings, but will demonstrate the findings for the Nature Reserve in its own section (Section 2) so that it can be easily shared with the County Council.

Approach

The agreed approach for this consultation was to use an online questionnaire. This approach enables an appropriate amount of explanatory and supporting information to be included in a structured questionnaire, helping to ensure that residents are aware of the background and context to each of the proposed areas by including maps. It is therefore the most suitable methodology for consulting on issues such as the adoption of Public Spaces Protection Orders. The consultation was available in print by request.

Promotion and communication

The consultation was promoted in the following ways:

- E-alerts, sent to subscribers of the council's email marketing service. These featured hyperlinks to further information about the consultation and the questionnaire itself.
- Information was provided on the news section of the council's website where the media get their information from.
- A link to the Public Spaces Protection Order consultation was also included on the 'Have Your Say' section of the council website home page for the duration of the consultation.
- Emails were sent to a range of support organisations and stakeholders.
- The council's Facebook and Twitter accounts were used to signpost people to the consultation information and questionnaire.
- Through the Lancashire Police and Crime Commissioner's office
- Through Lancashire County Council's Environment Directorate
- The Parish and Town Councils were invited to respond

Consultation respondents

In total **195** responded to the PSPO consultation, 193 of these were via the council's consultation portal and 2 representations were received by email.

All the questionnaire submissions that had at least one question completed were included in the analysis. It was important to include all responses even if only part answered as this was still feedback on the proposal. However, this does mean that the demographic information outlined may not cover all respondents, as some may not have completed this section. Where respondents chose not to answer a particular question, their no response was counted but excluded from the total percentage calculations per question.

Figure 1

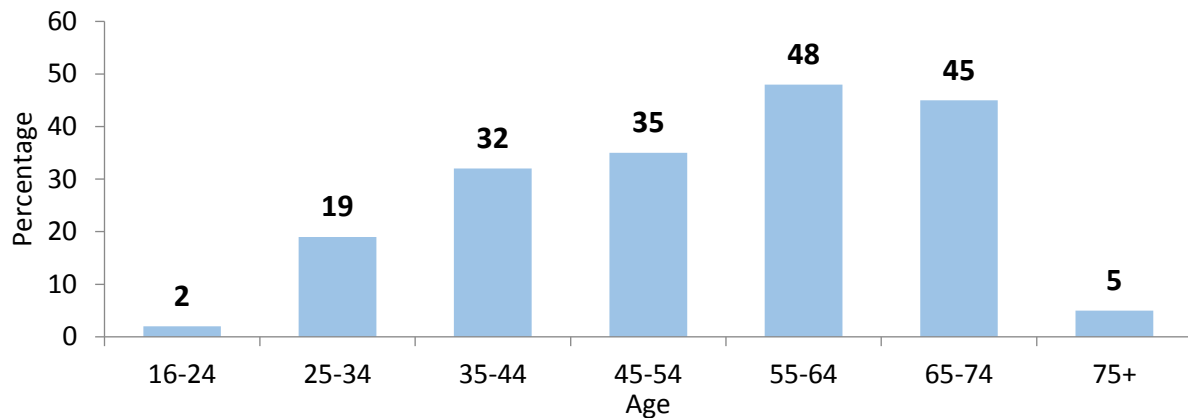

Figure 1 shows the age breakdown of the consultation respondents. The least represented groups were 16-24 and 75+ year olds, with 2% and 5% respectively fitting into these age categories. The group represented the most was the 55-64 year olds, with 48% of the overall respondents belonging to these age categories. This is in line with normal expectations as the over 45's tend to participate in greater numbers and make up a larger proportion of Wyre's population.

There was a significantly higher representation of female respondents (70%) to male respondents (30%). With 18% of respondents reporting to have a long term disability.

The majority of people responded as individuals (n=187/96%) with parish/town councils (n=3) business (n=1), community group (n=1) and Other (n=3).

Table 1 shows the geographic distribution of respondents organised into the following postcode groups:

Table 1

Postcode area	Number of respondents
<i>FY5</i>	88
<i>FY6</i>	29
<i>FY7</i>	47
<i>PR2/3</i>	9
<i>Other FY, LA and BB</i>	10

There were 9 responses without postcodes and the other representations were small in number or from other Fylde Coast postcodes and two from a Lancaster and a Blackburn /Pendle postcode.

As can be seen in Table 2 the majority of respondents own or care for a dog.

Table 2

Dog ownership status	Percentage of respondents
<i>You currently own or care for a dog</i>	67.02%
<i>You operate a business, care for/walk other people's dogs. You might also own dogs.</i>	3.19%
<i>You have recently owned or cared for a dog (in the past year)</i>	0.00%
<i>You have previously owned or cared for a dog at some point</i>	12.77%
<i>You have never owned or cared for a dog</i>	17.02%

Consultation results

Respondents were asked for their views on extending the existing PSPO's, along with suggested amendments and changes following the intelligence and feedback gained from the public and organisations since these were put in place. Consultees were given the opportunity to comment further on the proposals by sharing their opinions and experience of dog fouling in public places. In this aspect the results will help the council understand further what issues the public are facing and will be used as a consideration for future initiatives.

Summary of results – Section 1

Question summaries excluding comments. (for the comprehensive list of questions please see Appendix a16 The questionnaire)	Response %	
Do you have any comments or concerns regarding the extension of the order/offence in relation to...	Yes	No
Dogs fouling on land, and, the requirements of anyone in control of a dog/s to pick up the poo and put it in a bin?	23%	77%
The requirement to put dogs on leads by direction from an authorised officer?	21%	79%
The requirement to have dogs on leads in certain areas?	37%	63%
Should dogs be banned from the cemeteries?	System error. No response entries	
Dog exclusion areas?	47%	53%
The practice of other authorities is that the exclusion of dogs on unfenced marked pitches applies only when an organised activity is taking place. Do you agree with this proposed change?	74%	26%
Do you think the ban on the two bathing beaches should be applied all year round?	24%	76%
Do you think the ban on the two bathing beaches should remain seasonal (1 May to 30 September) but be limited to 10:00-20:00?	56%	44%
Have you any comments or concerns regarding the extension of the order that restricts the number of dogs one person can exercise at a time in certain areas?	36%	64%
Do you have comments or concerns regarding the extension of the order, where it is an offence to not have the means to pick up after the dog under your control when asked by an authorised officer?	13%	87%
Do you agree with the level of the Fixed Penalty for non-compliance remaining at £100?	76%	24%

Please note the above percentages have been rounded.

Summary of Results – Section 2 Fleetwood Nature Park

Following numerous complaints of dogs out of control on Fleetwood Nature Park, Jameson Road, and due to the negative effect on wildlife, Lancashire County Council wanted to engage the public regarding the following.

Question summaries excluding comments and maps. (for the comprehensive list of questions please see Appendix a16 The questionnaire)	Response %	
Lancashire County Council have asked if respondents agree with the control measures that...	Yes	No
Dogs be excluded from the lagoons and areas marked on the map 001 at all times?	41%	59%
Dogs must be on a lead in certain areas (see Map 002)	41%	59%
A maximum of 4 dogs be walked / under the control of one person is applied across the whole site (see Map 003)	65%	35%
There will be a requirement to pick up dog foul, and have the means to pick foul across that whole site (map -004 /005)	98%	2%
An authorised officer can instruct a dog to be put on a lead (see Map 006)	76%	24%

Section 1

Respondents were asked...

Do you have any comments or concerns regarding the extension of the offence relating to dogs fouling on land, and, the requirements of anyone in control of a dog/s to pick up the poo and put it in a bin?

76.96% (n=147) selected No in that they had no further concerns or comments regarding an extension of the order for the above question.

The 23.04% of respondents (n=44) that answered 'Yes' were invited to leave comments, of which 41 of them did. The majority of reoccurring themes relate to enforcement, that most dog walkers are responsible, and having more bins. A selection of comments are highlighted below. The full list of comments can be viewed in appendix 1:

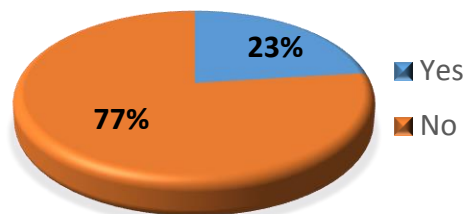

- The bi law should be upheld and the notice should not read you may be prosecuted to you WILL be prosecuted.
- The council need to create a bigger presence and issue more fines to dog owners who do not pick up poo the amount of dog foul about is awful.
- More enforcement of this is required - many public areas in and around Preesall and Knott End have significant dog fouling problems particularly at the weekends and early morning/evening.
- The extension to the order has to be extended, and, if possible enforced further. The incidence of dog fouling is increasing as more people have dogs (many obtained during lockdown).
- More wardens and more poo bins
- Dog fouling continues to be a problem, as a responsible dog owner I clean up for my dogs and at times feel the need to clean up for others to protect my children.

Respondents were asked...

Do you have any comments or concerns regarding the extension of the order in relation to the requirement to put dogs on leads by direction from an authorised officer?

79.47% (n=151) selected 'No' in that they had no further concerns or comments regarding an extension of the order for this requirement.

The 20.53% (n=39 respondents) that selected 'Yes' were invited to leave their comments, of which 36 respondents did. The main reoccurring themes were disagreement of having to put dogs on a lead and the acknowledgement that under certain circumstances it would be acceptable to be required to put a dog/s on leads. A few respondents wanted clarity of who is/are authorised officers. A selection of comments to reflect the above are highlighted below. The full list of comments can be viewed in appendix 2:

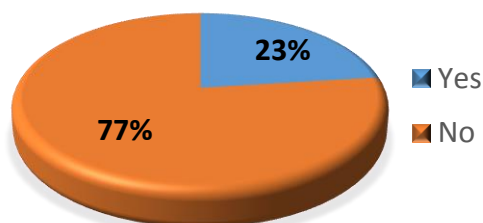

- Only if a dog is a danger to the public or other dogs
- Should there be an issue over safety to the dog or owner then I would have no objection to being asked to put dogs on a lead.
- I believe the dogs on leads by direction is a fair order which gives dog owners sufficient chance to exercise their dogs off lead at times and in places where it is safe to do so, for both dogs and other users of an area. It is entirely acceptable if a dog were to be causing a nuisance for an authorised officer to ask the dog to be put on the lead. My only concern is that sometimes it is not clear who an authorised officer is and on occasions this could be open to abuse by a council employee who may simply dislike dogs and ask for this to be done when the dog is not causing a nuisance. On balance I support this order.
- There are so few areas where you can properly exercise your dog and further extensions will restrict further these areas.
- Dogs need free exercise to enable socialisation with other dogs to enable better mental health.
- My dog needs to run and play, he can't do this on a lead.

Respondents were asked...

Do you have any comments or concerns regarding the extension of the order regarding the requirement to have dogs on leads in certain areas?

63.49% (n=120) selected No in that they had no further concerns or comments regarding an extension of the order for this requirement.

The 36.51% (n=69 respondents) that selected 'Yes' were invited to leave their comments, and 31 of them did. Opinions regarding the requirement to put their dogs on leads were mixed. A number of respondents agreed that under certain circumstances it would be fine to be required to put the dog/s on leads. A selection of comments to reflect the above are highlighted below. The full list of comments can be viewed in appendix 3:

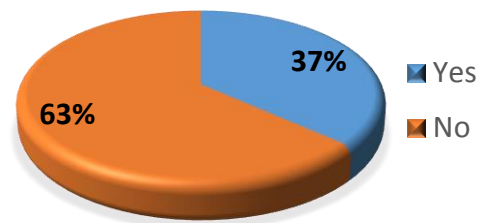

- While dogs should obviously be kept on a lead at times they must also be allowed off the lead to exercise and socialise as failure to do this can lead to some dogs becoming frustrated and potentially aggressive so it's imperative that areas are set aside for them to exercise and socialise safely.
- I certainly don't think that there is any requirement for further areas requiring dogs to stay on leads, if anything possibly a reduction should be considered.
- In certain areas is fine. However, I do NOT think there's a need to extend those areas
- All areas should be available, except fenced off children's play parks. People leave far more waste than dogs.

Respondents were asked...

Please note the following question was included in the consultation, however due to an unidentifiable glitch in the system no results were available.

Following the last round of consultation, dogs were allowed in the council cemeteries, with a requirement to be on a lead at all times.

These are not formal exercise areas, but have recently appeared to be used as such, with an increase in reports of owners not picking up after their dog, causing distress to visitors and complaints.

Should dogs be banned from the cemeteries?

Respondents were asked...

Do you have any comments or concerns regarding the extension of the order in relation to dog exclusion areas?

53.44% (n=101) selected No in that they had no further concerns or comments regarding an extension of the order for this requirement.

The 46.56% (n=88 respondents) that selected Yes were invited to leave their comments, and 81 of them did. The comments were mostly of the opinion that restrictions should be reduced, or are against the exclusion of dogs in areas. A selection of comments to reflect the above are highlighted below. The full list of comments can be viewed in appendix 4:

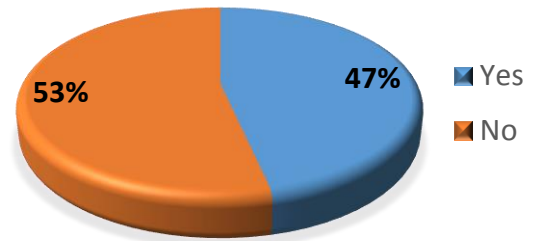

- Responsible dogs and owners should not be limited to where they can enjoy exercise. It greatly reduces our spaces. The amount of rubbish left behind by humans is far greater than by the minority dog owners. The devastation following lock down has evidenced this. More poo bins and higher fines for those not adhering is enough.
- Too many exclusions
- depends if you are thinking of increasing more exclusion areas, as stated dogs need run play and exercise
- Well trained dogs should be allowed in most places except maybe children fenced play areas.
- Dog ownership provides companionship to many and an opportunity to visit local parks, beaches etc for exercise and meeting other like minded people. I believe all local parks and beaches should be open to all and patrolled if there is an issue.

Respondents were asked...

Marked sports pitches, currently fall under the exclusion, however, many of these sites are not in use all of the time. When they are not being used for organised activity, unfenced pitches are reportedly being used for exercising dogs.

The practice of other authorities is that the exclusion of dogs on unfenced marked pitches applies only when an organised activity is taking place.

Do you agree with this proposed change? There will still be a requirement for people to pick up after their dogs and further signage will make this clear.

73.77% (135) selected Yes that they agreed with the proposed change.

26.23% (n=48 respondents) selected No.

All respondents were invited to leave comments for this question, and 89 (45.64%) of the 195 did.

The respondent's comments were mostly highlighting the reasons why they didn't think that dogs should be allowed on sports pitches, and mainly health reasons were given. Those that supported it did so responding as responsible owners. A selection of comments to reflect the above are highlighted below. The full list of comments can be viewed in appendix 5:

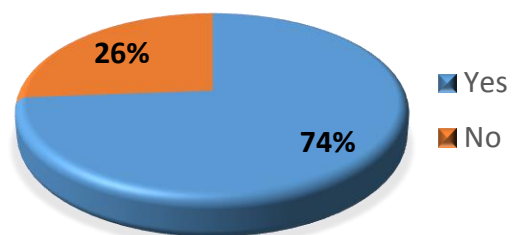

- My observation is that people exercising dogs on playing fields frequently let their dogs off their leashes-and in such circumstances, definitely do NOT pick up after their dogs. Is it fair that whoever then uses the field for a game or other activity should have to contend with the subsequent fouling.
- A dog walking space should not be in areas where regular activity takes place by our young people. It is not always possible to pick up all traces of dog poo plus dogs will also urinate in these spaces making them unhygienic for any kind of sport.
- People make pick up after their dog but some faeces will still remain and there is the possibility of worms from untreated dogs. Children then roll on the grass that has been used for urine as well. Allowing dogs on even when owners pick up encourages other less responsible owners to also allow their dogs to foul the area.
- even when owners do pick up after their dogs, the area remains soiled. Pitches cannot be cleaned before use for sports.
- There is no reason why responsible dog owners shouldn't be allowed to use unfenced spaces when not in use. There should be punishment of some sort for irresponsible dog owners though as they spoil it for others.
- logical amendment in line with most LAs

Respondents were asked...

Do you think the ban on bathing beaches should be applied all year round?

The majority of responses were against the ban being applied all year round i.e. 72.31% (n=141).

All participants were invited to leave comments and 56.41% (n=110) did.

Mostly these comments further supported why there should not be a ban on the bathing beaches all year round. The majority of respondents gave the reasons of low usage by the public and bathers during the winter months. There were also a high number of comments regarding other users, not dogs, being the main reason for litter and rubbish. Those that supported the ban all year round which were fewer in number, did so from a protection of wildlife and fauna perspective and many felt that there could be further confusion which part of the beach should be used and when. A selection of comments to reflect these points are highlighted below. The full list of comments can be viewed in appendix 6:

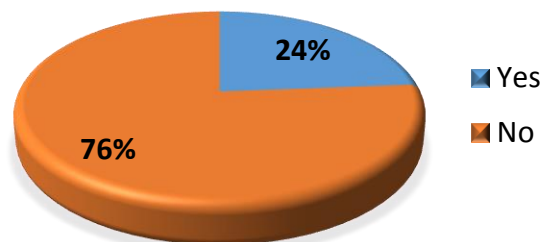

- It's dead 6 months of the year. Why not allow local dog walkers to enjoy their town's beauty spots.
- Beaches out of season are often quiet and provide excellent exercise areas for dogs. Wind and rain may deter bathers but rarely deter dog walkers.
- The beaches are mainly used by dog walkers once the summer season is over. I understand limiting the areas dogs can go on during the summer months though. Sadly it is people/fishermen who leave most of the rubbish on our beaches not dogs.
- I walk my dogs on the beach most days, I have no problem in not walking them on the small portion of the beach where they are not allowed. Some people do not like dogs and there should be an area where they can go and use the beaches without fear of being molested by dogs, any responsible dog owner should agree with this - being a "responsible dog owner" is more than just picking up your dog's poo, it is also about good interaction with other people.

- There are nesting birds in the shingle at Rossall and VERY rare plants including sea kale and yellow horned poppy in this area. Plus the biological database habitat species of honeycomb worm on the grounds. These are should be top priority if we are to protect our biodiversity.

Respondents were asked...

Do you think the ban on the two bathing beaches should remain seasonal (1 May to 30 September) but be limited to 10:00-20:00?

The results were more balanced for this question with 56% (n=100) saying that they agreed the ban should remain seasonal but be limited to 10:00 – 20:00, and 44% (n=79) selected that they didn't think the ban should remain.

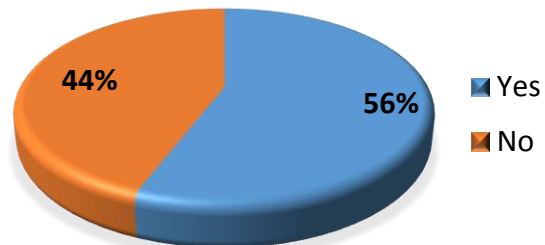

There were 90 responses (47.69%). Of the majority that agreed with the time limitation and then went on to leave comments the general expressions were that it was fair, and enabled dog walkers to use the beaches when they are at their most quiet, and they said, this is when many walkers take their dogs out. There were a slightly higher number of comments left where the respondent didn't agree with the proposal, and there was a mixture of reasons. People were concerned that specific times may serve to confuse people, some that it should just remain. There were those that felt that there should be no ban at all, and others indicated that time was not the issue. A number of respondents also mentioned better monitoring and enforcement. Please see appendix 7 for the full comment list.

- It would be fair to all
- This would be a perfect compromise
- Many dog walkers exercise their dogs early and late.
- As long as people are picking up their poo. Most people have left the beach by then.
- I agree a time restriction during the ban - if it actually needs to be in place at all, however 10am till 6pm seems more reasonable and is adopted by other councils down south. There's confusion with the public and visitors, keeping it the same all the time would stop this
- The timing makes no difference. Dog excrement is a pollutant that is not time restricted.
- No limitation. It's no use turning up to use the Marine Beach only to find the early morning dog turds. Better enforcement, more fines please. Keep our public areas clean!
- It should stay as it is. People know the rules. Why change them?
- No beach ban is necessary seasonal or otherwise, look how much waste is left by humans in comparison

Respondents were asked...

Have you any comments or concerns regarding the extension of the order that restricts the number of dogs one person can exercise at a time in certain areas?

There were 79 responses to this question. The responses were split by opinion across general themes, mostly comments agreed with 4 dogs per person or referred to specific number less than 4, mostly the suggestion was 2 dogs. A fair number commented that the issue was about a person having control of the dogs, and not the number of dogs exercised. Some mentioned introduction of a licensing scheme for professionals as dog walkers were referred to as being disadvantaged and restricted by the numbers. The full comments are listed in appendix 8.

Respondents were asked...

Do you have comments or concerns regarding the extension of the order, where it is an offence to not have the means to pick up after the dog under your control when asked by an authorised officer?

15 people (7.69%) commented on this question. The main themes of the comments were around the concern that owners can exhaust their bag supply whilst out. A number suggested that enforcement officers could give bags. Many comments supported the order.

The full list of comments are listed in Appendix 9

Respondents were asked...

Do you agree with the level of the Fixed Penalty for non-compliance remaining at £100?

76.06% (n=143) of the 195 respondents agreed with the level of fixed penalty for non-compliance. 45 (23.94%) people disagreed

37 respondents further commented on the order. The comments were split with slightly more people intimating that the fine should be higher, than the number of respondents saying it should be lower.

Some expressed that a fairer system of enforcement could be employed first e.g. warnings.

The full list of comments are listed in appendix 10.

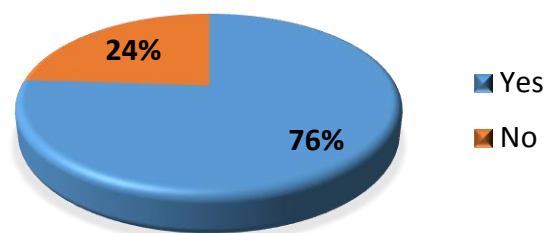

Appendix 1 - Do you have any comments or concerns regarding the extension of the offence relating to dogs fouling on land, and, the requirements of anyone in control of a dog/s to pick up the poo and put it in a bin?

A1

	Please detail your comments/ concerns below
1.	Who are the authorised officers?
2.	I think considering the state the local beaches have been left in recently, dog poo is the least of our troubles. Only a very small minority don't pick up, I don't agree with the extension, ban the humans leaving litter!
3.	The order should be renewed. But it is no good renewing it if you don't enforce it. I go onto the beach nearly every day and I see people ignoring the no dogs on the beach rule almost every day. When I pointed it out to you employees they tell me it is not their job to point out the rule to the dog owners, and neither is it their job to contact your office and inform the enforcement officer of the situation. I do think you do need to enforce the bylaw if you are going to renew it.
4.	Yes, I am disgusted by those dog owners who still refuse to follow the guidelines and rules, that minority need to be caught and dealt with.
5.	There are still too many dog owners not cleaning up after their animals. The Order should also include horses. I walk along the promenade between Rossall school and Rossall Point and see too many deposits from both dogs and horses. I have never encountered any problems with dogs off the leash and think most people who exercise their dogs are responsible owners.
6.	More bins required, particularly at Stanah.
7.	More enforcement required and ramifications for those irresponsible owners who do not pick up their dogs mess. Equally, more bins would be very useful Over Wyre, especially throughout Preesall and Knott End.
8.	I think it would be a good idea to have a dog poo bag dispenser at busy areas. Maybe a pay to use machine? For people who have forgotten theirs or have run out of bags.
9.	The council need to create a bigger presence and issue more fines to dog owners who do not pick up poo the amount of dog foul about is awful.
10.	The bylaw should be upheld and the notice should not read you may be prosecuted to you WILL be prosecuted.
11.	The proposals seem to target multiple dog owners, when in fact most poo appears to be left by irresponsible single dog owners. Limiting numbers of dogs exercised by one person or enforcing lead only will not solve the problem.
12.	Fleetwood Nature Reserve - I wonder how a person with several dogs off the lead can be aware of when their dogs defecate. I frequently see owners with dogs running around whilst they are busy on their phones. They are totally unaware of what they are doing, I have even rescued a poor aged dog who had strayed from its owner for well over 15 minutes before another walker helped me find the owner; they were totally unaware it

Appendix 1 - Do you have any comments or concerns regarding the extension of the offence relating to dogs fouling on land, and, the requirements of anyone in control of a dog/s to pick up the poo and put it in a bin?

	had strayed away. More than 2 dogs off a lead become a pack which can often be unpleasant and intimidating for other walkers. Dog fouling on the paths and bridge is often a problem but more so when the dark nights come.
13.	More wardens and more poo bins
14.	We have 2 dogs and we pick our poo up and our dogs are well behaved and come back to us when called I think you should tackle the owners that don't care what their dogs do.
15.	There appears to be little or no enforcement of the rules; both Fleetwood Nature reserve and the Wyre Country Park reek of dog poo nearly all the time.
16.	The extension to the order has to be extended, and, if possible enforced further. The incidence of dog fouling is increasing as more people have dogs (many obtained during lockdown).
17.	More bins, walking from Thornton to Cleveleys down Victoria Road East, the last bin is Four Lane ends near the traffic lights, going up to Cleveleys. The next bin is well into duck pond. In my opinion if more bins were about dog owner would pick up and bin. Also in park space Blackpool Council supply bags near bins in their shared public space.
18.	That dog owners should pick up the poo and put it in the bin. Maybe cameras in place to enforce the fining system
19.	As a responsible dog owner I feel that there should be firm measures to tackle those who don't pick up that give us all a bad name. My friends agree.
20.	Most dog walkers I know are responsible and do pick up after their dogs. We as a community pick up after ourselves to keep it clear for all of us.
21.	For the people who let their dogs foul on land, the people who are responsible dog owners get penalised
22.	Too many dogs not under control disturbing wildlife including ground nesting birds and rare plants such as orchids
23.	Dog fouling continues to be a problem, as a responsible dog owner I clean up for my dogs and at times feel the need to clean up for others to protect my children.
24.	This one reply is for all the questions. I have never seen an enforcement officer and the local rangers turn a blind eye. In Lancs county heritage site 34NW06 report it states that The site is of substantial interest for its flowering plants supporting 6 species on the red data list of vascular plants and is of county significance for birds. Cleveleys grows Sea kale which is classed as rare and appears on a Wyre sign at Rossall. Last time I looked it was covered in dog poo. Ringed plovers nest are on the shingle and near to the beach is honeycomb worm classed as a BAP a biodiversity action plan priority species, now used as a dog pee area. Stricter rules all round should be enforced I believe in education but

Appendix 1 - Do you have any comments or concerns regarding the extension of the offence relating to dogs fouling on land, and, the requirements of anyone in control of a dog/s to pick up the poo and put it in a bin?

	with enforcement behind it. In this world of dwindling resources I ask you to act and let those who enjoy nature do so in peace and with respect.
25.	I support the proposal.
26.	There's a huge increase in the amount of fouling on pavements that isn't cleaned up. Horse owners also shouldn't be allowed to do this on pavements either as that happens regularly.
27.	It appears that Dog Walkers are constantly being penalised, when all they are doing is providing a service for disabled, elderly and full time workers who choose to own a dog but for whatever reason cannot walk the dogs themselves. Anyone who has ever owned a dog knows how a dog can help disabled, elderly and lonely people, the only reason this is now possible is because of the dog walkers. I have met several dog walkers, that walk dogs on Fleetwood Reserve, they all pick up their dog mess, however I have witnessed plenty of dog owners NOT picking up after their dogs as a lot of them are taking no notice of their dog/s. I have been shouted abuse at when I have offered these dog owners a poo bag. I have also witnessed dog walkers picking up dog mess that their dogs haven't done. It seems to me that the dog owners and walkers are blaming dog walkers as they are easy scapegoats. If these honest, reliable, tax payers, caring dog walkers are penalised in this way, they will end up not working providing a fantastic service, most of these lovely trustworthy people will be forced to claim universal credit, which would be a massive drain on the community. Rather than wasting all this money and resources on changes for dog walkers, maybe the council would be better putting these resources where they are most needed. Hundreds of thousands of pounds are spent everyday moving fly tipping, maybe the money would be better spent here, in fact if a dog walker hadn't been behind a person that was fly tipping and taken a picture, someone else would have got away with another criminal offence. Please stop penalising people that are just trying to earn a crust.
28.	Most dog owners pick up their pet's poo, and you will often find (myself included) that other dog owners will pick up poo left by other dogs where the owner has not picked up. The majority of dog owners/walkers are following the rules about picking up poo. It is a shame that we are being penalised by the few who do not.
29.	There is nobody watching and checking people's behaviour.
30.	I am very concerned that dogs are being allowed to be exercised on public playing fields. I was annoyed that the owners of 3 dogs were using the football field at Preesall to exercise their dogs. Please could you put this in the restricted places that dogs are not allowed .
31.	Fines for not picking poo should be increased.

Appendix 1 - Do you have any comments or concerns regarding the extension of the offence relating to dogs fouling on land, and, the requirements of anyone in control of a dog/s to pick up the poo and put it in a bin?

32.	Professional dog walkers using vans for multiple dogs, especially in small community areas should be licensed so that they can be better controlled as to where they are allowed to walk multiple (often 8 or 9) dogs. Often these professional walkers do not pick up after the dogs in their charge and visit a small area up to three times a day. This unfairly puts pressure on areas used by local dog walking residents, and can give the impression that residential users of their local area are causing a dog fouling problem, when it is often people in these vans causing the problem. As a regular user of my local park (over 22 years) and as someone with a disability I rely on this area to walk my dogs and do not want to be penalised because of inconsiderate action by commercial dog walkers.
33.	More enforcement of this is required - many public areas in and around Preesall and Knott End have significant dog fouling problems particularly at the weekends and early morning/evening.
34.	People should pick up dog poo if they own a dog.
35.	Sometimes people do not clean up areas where children are. Those people that do pick up the dirt do not always put it in the bins as there may not be one nearby so they just leave it anywhere.
36.	Ref Fleetwood Nature Park, dog owners regularly pick up dog poo but then hang the bag on the steel railings adjacent to the model flying club.
37.	This must include taking the waste home if the bin is full or otherwise unavailable.
38.	Dog muck on Esplanade and sea wall between Preesall and Knott End.
39.	I walk daily on the Lower Walk between the old hospital site at Rossall and Fleetwood ferry. Despite the enforcement order and new bins, some dog owners are still not cleaning up after their dogs. Can you please have more visits by enforcement officers and fines handed out. The odd blitz could drive the message home that this behaviour is completely unacceptable. Some more bins at the Rossall end would help. Also, all the painted warnings on the floor seem to have worn off. I thought they were a good idea, could they be re-done?
40.	Although much better of late those people purporting to be "professional" dog walkers and those people who exercise more than two dogs are unable to watch all their dogs at any one time and of course fouling occurs ... excrement not deliberately left just the act is not witnessed.
41.	When walking through the nature reserve I have never seen anyone fail to clean up after their dog.

Appendix 1 - Do you have any comments or concerns regarding the extension of the offence relating to dogs fouling on land, and, the requirements of anyone in control of a dog/s to pick up the poo and put it in a bin?

A2

	Please detail your comments/ concerns below
1.	Mainly on Cleveleys promenade, there are frequently dogs off their leashes running amok & annoying other dogs that are on leashes as well as other promenade users. There are also a countless number of dogs-both on & off their leashes in the dog exclusion area on a daily basis. I am frequently on the promenade & I have NEVER seen ANYONE monitoring or patrolling on the promenade or beach to stop anyone from disobeying the PSPO. If you have these laws in place, you MUST police it in some way or else it's worthless.
2.	Mainly on Cleveleys promenade, there are frequently dogs off their leashes running amok & annoying other dogs that are on leashes as well as other promenade users. There are also a countless number of dogs-both on & off their leashes in the dog exclusion area on a daily basis. I am frequently on the promenade & I have NEVER seen ANYONE monitoring or patrolling on the promenade or beach to stop anyone from disobeying the PSPO. If you have these laws in place, you MUST police it in some way or else isn't worthless.
3.	Dogs should be allowed off leads when it is safe and sensible to do so.
4.	Only if a dog is a danger to the public or other dogs.
5.	I am happy to put my dogs on lead when advised to do so, however, they are only let off where it's allowed to do so. In on lead areas, having this reinforced might be a good idea though, considering many people with nervous, reactive and recuperating dogs use these as a safe area and the last thing they want is loose dogs running up.
6.	Unfair bias against dogs.
7.	Dogs need their freedom but if not under control then on a lead.
8.	This is one of the only areas that is safe to take dogs in the local area where they can get the required amount of exercise and are not at threat or danger from cars on the roads. I have two springers and keeping them on a lead is detrimental to their health as they need to run for miles and this isn't possible whilst on a lead.
9.	As I understand it, the law states that dogs must be kept on a lead on public land? I believe this includes footpaths, public spaces such as parks and playgrounds? There is seemingly a misconception that a park is an area where owners can let their dogs run free, this is certainly the case in Preesall and Knott End. Preesall Park is a dogs free for all, the Park also has football pitches that are used by many football groups, dogs are allowed to run free on these pitches, it is also a dogs toilet. Jubilee gardens in Knott End is another area where people let their dogs run free, it is a small public park with flower beds and seating areas. I am a member of the Knott end and Preesall bloomers group and we regularly have to remove dog mess and litter from this area before we can garden and recently I was snapped at by a loose dog whilst here, no damage was caused to me but the potential was there. The dog has never snapped at anybody before but it has now!

Appendix 1 - Do you have any comments or concerns regarding the extension of the offence relating to dogs fouling on land, and, the requirements of anyone in control of a dog/s to pick up the poo and put it in a bin?

	Please detail your comments/ concerns below
10	Dogs should be free to be off lead here. They need to be able to run and isn't a perfect area for this.
11	yes depends which area dogs do need to run and exercise
12	Dogs need free exercise to enable socialisation with other dogs to enable better mental health.
13	Some dogs need the ability to run off, therefore it may be more appropriate to find a space that the public know there will be dogs running off their lead, so to avoid if they don't like this.
14	There is very little places for dogs to run free this is something that is paramount to their mental and physical wellbeing, I've walked my dogs on there without any incident off lead for many years, if the people who don't want to walk their dogs where others are off lead I suggest they walk on the street where all dogs must be on a lead
15	See below (the respondents comments were on the Nature Reserve later on in the survey and so will be captured there).
16	Dog owners seem to think that this nature reserve is an extension of their own gardens and treat it as such. It is a nature reserve.
17	Some dogs require a run off lead, it is good for their mental health and fitness. I feel they should only put their dog on a lead if it does not have good recall (ability for dog to come back when owner calls), has aggressive issues towards other animals or people, and should be kept on a lead when areas are busy. On an empty field for example there should be no issue as long as they pick up after their dog.
18	Yes, as a dog walker in a village, the only open space (Scott's green) is no dogs off lead. I feel that this space would be better served by a put your dogs on leads by a direction from authorised officer on the whole most people on the green are respectful and this would serve as sufficient. However, with the blanket ban, it is discouraging the locals from using this space, which I feel is a massive shame.
19	My dog needs to run and play, he can't do this on a lead.
20	I support the proposal.
21	There must be areas that dogs can run free , under control from owners.
22	Dogs often spend most of their life indoors on their own while the owner is at work, the only time they get to themselves is going on a walk and stretching their legs and enjoying their only bit of freedom we give them. Are we really going to restrict their freedom even more by not allowing them off lead to stretch their legs?

Appendix 1 - Do you have any comments or concerns regarding the extension of the offence relating to dogs fouling on land, and, the requirements of anyone in control of a dog/s to pick up the poo and put it in a bin?

	Please detail your comments/ concerns below
23	Dogs required time off lead to explore their surroundings, grow their nose portfolio and to socialise with other dogs on a more relaxed environment. Certain breeds require more exercise than others therefore the option of being off lead helps let them burn off the excessive energy.
24	There are so few areas where you can properly exercise your dog and further extensions will restrict further these areas.
25	I cannot believe how it was allowed in the first place! Why in a nature reserve would you think of allowing dogs off leads! They run in the ponds chasing the ducks and swans it is disgusting!! The owners are also unaware of where the dog has done isn't business as it has been out of sight.
26	Dogs must be allowed areas where they are free to exercise off the lead.
27	I believe the dogs on leads by direction is a fair order which gives dog owners sufficient chance to exercise their dogs off lead at times and in places where it is safe to do so, for both dogs and other users of an area. It is entirely acceptable if a dog were to be causing a nuisance for an authorised officer to ask the dog to be put on the lead. My only concern is that sometimes it is not clear who an authorised officer is and on occasions this could be open to abuse by a council employee who may simply dislike dogs and ask for this to be done when the dog is not causing a nuisance. On balance I support this order. My local area is NORTH DRIVE PARK CLEVELEYS. I would like to see this order retained for this park which I use daily and is vital for me to access as with my mobility issues. I need an area to access that also has seating so I can walk the dogs a bit, sit a bit and walk again. A lot of elderly people with mobility issues and dogs use this area for the same reason. We do encourage others to use the park responsibly.
28	Officers should be in uniform. Make themselves known and engage with dog walkers. Too many hide away, gather evidence and then the engagement between officer and dog walker is often negative from the get go.
29	Could this be extended to cover requests from other people?
30	It should be a sensible owners decision.
31	I have an issue for what you are intending by this order. There is no question that dog owners should not be allowed to leave poo on the ground. But most dog owners who use this space do that. What you are talking about doing will massively impact a number of people who use these facilities to gather and socialize. While the person who is dreaming up this appalling rule might not get it as they are not a dog owner. They will be impacting lots of people and also their dogs. There are a number of reasons why this order is a horrid idea. The dogs benefit from going into the clean water on hot days. The owners and dogs benefit from allowing their dogs to run off the lead with other dogs, create better behaviours in dogs community spirit.

Appendix 1 - Do you have any comments or concerns regarding the extension of the offence relating to dogs fouling on land, and, the requirements of anyone in control of a dog/s to pick up the poo and put it in a bin?

	Please detail your comments/ concerns below
32	I do find they can be over zealous sometimes with people. For instance my dog is under full control even when off lead.
33	I am very concerned at this requirement. I have exercised and socialised my dog at the nature reserve for several years. A vast majority of the dogs which are exercised here are externally friendly and well trained. It is important for dogs to be active and receive off the lead socialisation with other breeds of dog in order to prevent any aggression or other poor behaviour traits. Requiring dogs to be on the lead at all times will simply lead to unhappy dogs and owners. Owners enjoy being able to chat with one another whilst the dog run and play together. It is extremely concerning that the council would want to in act such measures as these, there is no harm in dogs socialising and playing off the lead while owners are being attentive at all times. It is disgusting that the council want to prevent dogs being social and friendly to other dogs.
34	Please will you include Garstang TCs resolution from last night's TC meeting (17/8/20) in the consultation exercise 056(2020-21) Wyre Council "3 Year Review of Public Spaces Protection Orders (PSPOs)" Control of Dogs and Dog Fouling, Cllrs Hynes and Webster Resolved: The Town Council approved Cllr Hynes comments: The High Street Riverside area is already marked down on the schedule, as a Dogs on lead area, which the TC feel is appropriate for this section of Garstang. Many families picnic here and in the summer is very popular with youngsters playing along the edge of the river. At the moment, many people are not adhering to this and dogs are not on leads and many a times have caused chaos amongst happy families enjoying their picnic, running into the river knocking children over and also attacking ducks. Signage is desperately needed to educate the owners that this a Dogs on lead area. I would suggest 3 signs would be needed -1 coming from the Millennium Green, and 2 either side between the carpark and duck area. Additionally, once the signs are in place, Garstang Town Council request that the signs are enforced and the dog fouling is addressed, by asking the enforcement officer to show his presence.
35	The instruction would be, I am certain, complied with by the majority. Not known of it in the last three years but it might be used as a tool in exceptional circumstances in the future.
36	Should there be an issue over safety to the dog or owner then I would have no objection to being asked to put dogs on a lead.

Appendix 1 - Do you have any comments or concerns regarding the extension of the offence relating to dogs fouling on land, and, the requirements of anyone in control of a dog/s to pick up the poo and put it in a bin?

A3

	Please detail your comments/ concerns below
1.	I certainly don't think that there is any requirement for further areas requiring dogs to stay on leads, if anything possibly a reduction should be considered.
2.	There are too few areas where our dogs can be exercised safely.
3.	In certain areas it is fine. However, I do NOT think there's a need to extend those areas.
4.	Fleetwood Marsh nature reserve is just that and the wild animals should have precedence over walkers and dog owners. We have had 5 swans since spring but none have produced young and I wonder if it the number of dogs who chase the swans in the ponds are deterring them from breeding. We have had Great crested grebes, reed buntings, Peregrine falcon, shoveller ducks, tufted ducks, moorhens, coots and many more beside bats and common newts. Too many think it is fine to allow their dogs to chase birds in the ponds. I think dogs should be on the lead during breeding season, after all this is a nature reserve not a dog toilet.
5.	All areas should be available, except fenced off children's play parks. People leave far more waste than dogs.
6.	As above.
7.	Limiting the area that dogs are not allowed off lead will be very detrimental to a lot of dogs wellbeing, including mine. There are now no other areas where dogs are allowed off lead.
8.	On numerous occasions, particularly since COVID 19 restrictions on travel whilst walking with very young children I have encountered dogs off the lead and out of control, owners seem to feel they have the run of all the beaches now. Dogs have leapt at the children knocking them off their feet and on two occasions I have had to shield the children from snarling aggressive dogs. Many owners have more than one dog off the lead and are not in control, the extendable leads are a particular nuisance on narrow roads and paths, the lead as well as the dog forming a hazard to both old and young. I feel that dogs should be on a lead at all times and owners should not be allowed to exercise more than two dogs at a time.
9.	Dogs should be kept on a lead in all public areas at all times especially where other people are present.
10	Unnecessary.
11	As above dogs need to run and play.

Appendix 1 - Do you have any comments or concerns regarding the extension of the offence relating to dogs fouling on land, and, the requirements of anyone in control of a dog/s to pick up the poo and put it in a bin?

	Please detail your comments/ concerns below
12	<p>The areas where dogs can be exercised off lead and allowed to play and run together are reducing more and more but no alternatives are being provided. High energy dogs (of any breed) need mental and physical stimulation that cannot be met when on lead. In addition, that unspent energy coupled with the added tension of being on lead increases the anxiety levels of dogs (it is very common for on lead dogs to be more reactive). If these proposals do go ahead then please consider securely (solid, not like the other metal fences with gaps) fencing and gating the off lead area as this clear segregation will; a) benefit both dog owners and non owner groups b) allow those wishing to exercise off lead to have a secure area to somewhat compensate for the greatly reduced size c) remove the issues between dog owners who don't want off lead dogs socialising with their on lead dogs by creating a clearly defined area where everyone knows dogs are off lead. In the absence of an American-style dog park (which would be lovely!) providing this enclosed space for off lead play would help all groups.</p>
13	<p>It would stop dogs swimming in the pond.</p>
14	<p>All dogs should be on leads and the number per person strictly limited.</p>
15	<p>I support the proposal.</p>
16	<p>I would like the authority to consider having seasonal lead orders, for example like the beach at Cleveleys this could be applied to Fleetwood Marsh which would protect the newly hatched birds and those adults/children who are brought by parents/ carers to feed the ducklings etc if they are nervous of dogs. My dogs need walking rain or shine, the issue is non dog walking adults and children using the Marsh has been exacerbated by the nice weather and covid 19. Usually on wet/ windy days it is only the hardened dogs walkers that you will see on the Marsh. My dogs have good recall however it would be difficult to keep them when off lead in the boundaries proposed without fencing, the authority could consider having a fenced area where children/adults are fully informed that there will be dogs off lead. I was diagnosed with Cardiomyopathy(enlarged heart) caused by a missed infection by medics 3 years ago and was under the care of Blackpool Victoria Hospital at this time we welcomed 2 dogs into our family I have walked daily (however at nearly 60 years I don't run). My young dogs need time to off lead and these proposed restrictions will make that very difficult for me to get the right balance of exercise for us all, 8 months ago I was discharged from the cardiac unit as my heart has returned to a normal size and this is directly due to my use of Fleetwood Marsh and Cleveleys and Rossall beach.</p>
17	<p>While dogs should obviously be kept on a lead at times they must also be allowed off the lead to exercise and socialise as failure to do this can lead to some dogs becoming frustrated and potentially aggressive so it's imperative that areas are set aside for them to exercise and socialise safely.</p>

Appendix 1 - Do you have any comments or concerns regarding the extension of the offence relating to dogs fouling on land, and, the requirements of anyone in control of a dog/s to pick up the poo and put it in a bin?

	Please detail your comments/ concerns below
18	I think dogs should be kept on leads in all public areas at all times except for designated areas where dogs can be exercised off a lead. I have a spinal disability and consequent poor balance and find it difficult to find anywhere to walk without having dogs running at me which can very easily cause me to fall. Unfortunately dog owners do not comply with the by-laws and it is impossible for the Council to police the issue.
19	Clearer signage would be helpful particularly on the prom.
20	If this is going to be a law, then there needs to be fences and gates put up where dogs must be on a lead plus or are not allowed. I have to say I have never witnessed a dog run after the ducks or any birds I have however seen families and young children throwing stones at the birds.
21	See above. There are so few open spaces left where you can exercise a dog and further restrictions would be unfair.
22	It should be ALL areas.
23	Question is not English!!
24	I support this order in places where it is primarily for safety reasons. Pavements etc... dogs were always allowed off lead on the Promenades but now this is on lead. I am happy however to support this order for the safety of my dogs as due to the number of cyclists that use the promenade as a race track it is not safe FOR THE DOGS to be off lead. It's a shame there is not an order controlling the cyclists and their actions on the promenade areas. They have nearly mowed me down several times. As long as this order is balanced by access to sufficient off lead areas for exercise (ie the beaches) I would support it.
25	Catterall Parish Council wants to include ALL the play equipment under dogs on leads. That being the children's play area, older play area, wheeled play area, reading corner, landscaping areas, Multi Use Games Area and central football pitch. Map included.
26	Yes because it will be a nightmare to know where and when
27	As above. Also if this does go through you can expect a very hard time as this "survey" has been done in a way to hide any obligations. If this does come in you can expect a serious backlash from a number of owners.
28	I am concerned this rule will be extended to too many areas leaving nowhere left in the Wyre area.

Appendix 1 - Do you have any comments or concerns regarding the extension of the offence relating to dogs fouling on land, and, the requirements of anyone in control of a dog/s to pick up the poo and put it in a bin?

	Please detail your comments/ concerns below
29	<p>At the Fleetwood nature reserve for example in the summer months there is no shade provided by trees or shelters so the water is the only way that dogs can cool down. If people were to have the dogs on the leads it would cause many accidents because the owners would be slipping on the rocks while their dog is trying to get to the water. I understand that the lake is not there just for dogs to use but in my many years of going to the reserve I have seen that the swans, ducks etc are not bothered by dogs entering the water and any that are simply swim to the other side or under the bridge for the five minutes the dogs cool down. By all means stop people from throwing balls in for their dogs but surely it's in the health and well-being of the dog to allow it to paddle and cool down for a few minutes? Could half the lake be assigned to families and picnickers and the other side for dog owners that way the reserve can be used by everyone all year round otherwise you'll be excluding a lot of people from being able to take their dog their as it's hot and they need to cool off and with restrictions everywhere else there really isn't anywhere else to take them? Speaking of picnickers they create and leave an awful lot of mess and it's us dog owners/walkers that clear it up when they leave. The children at the reserve are constantly throwing rocks at the swans etc on an almost daily occurrence. Are these people going to have restrictions imposed because they create a lot more mess and damage than dog owners do? Also unless you physically build a fence around that lake there is no way you'll be able to stop a dog in summer from entering the water to cool off. I've seen people with Labradors that head straight for it because that's the nature of the breed. After years of the dog being allowed to cool off it's not going to suddenly understand there's an invisible line it can't cross and it can't do so and to fine the owner £100 each time is totally unfair. People are afraid to take their dogs out because of enforcement officers waiting to pounce.</p>
30	Not really enforceable 24/7
31	<p>First of all I'd say that WBC's attitude to dog ownership is quite appalling. The signs suggesting dog ownership is the same level of public nuisance as fly-tipping is a disgrace. My specific issue is with the Fleetwood nature reserve. I have been taking my dogs there for twelve years and have them under control. I've rarely seen dogs out of control, certainly fewer times than I've seen youths and children out of control. The recent COVID problem has now brought out the lycra brigade who treat it as a leg of the Tour de France. In a shared space I see no more reason to put a dog on a lead than a young child. Both are capable of making sudden movements and it is up to cyclists to be aware and act accordingly.</p>

Appendix 1 - Do you have any comments or concerns regarding the extension of the offence relating to dogs fouling on land, and, the requirements of anyone in control of a dog/s to pick up the poo and put it in a bin?

A4

	Please detail your comments/ concerns below
1.	There should be more of them. Try finding a grassy place you can take your family in Wyre that is not a dog toilet!
2.	I agree with the dog exclusion area on Cleveleys beach. I do wonder why these rules are not being enforced and fines taken. When my husband and I and friends walk on the prom a few times a week we see several dogs all the time on the banned section of the beach. At this time of year and especially now with so many people coming to the beach with children the dogs should not be on the beach. Some people take absolutely no notice of the signs or the flags banning them. If people see dogs on the beach they will think, well if there are dogs on now ours can go on. Have the Council any intention of policing the beach especially at weekends and Bank holidays? If not what is the point of having a ban? The fines that would be taken would surely pay for a dog warden.
3.	Areas excluding dogs must be clearly signposted.
4.	Banning all dogs from the beach - we have a rescue dog ex puppy farm, and walking on the beach has been such a delight for her. This poor girl has been cruelly exploited by humans who now want to confine her to concrete paths. The problem with dogs going on beaches is not all dogs, it's a few rubbish owners.
5.	No dog should ever be on or in an area used by children or vulnerable or disabled persons.
6.	Closure of beach is too long.
7.	Do not exclude from nature park or beaches on Fleetwood other than those already designated. Dogs should be free to run safely and if they are excluded from nature park or other parts of Fleetwood then you are severely hindering freedoms of choice I feel and the place we live in shouldn't all be restricted. Lots of dog owners are conscientious. It's only a few who aren't. Don't punish everyone else for the bad ones, rather educate and fine those bad owners.
8.	There are areas where the dog exclusion zones are not warranted. For instance, part of the pitch and put golf course on the front half of this course is never used and therefore dogs would be able to be exercised on the completely unused half!
9.	Bring back the dog ban for the Cemeteries, there are dogs off their leads, weeing on headstones and poo on graves. It is disgusting.
10.	I think it is unhelpful to put all dog owners together. There is no bad dog, only bad owners. I think the law should not to ban all dogs, but have dogs on a lead, and extended leads if at all.
11.	Again there are too few areas where our dogs can be exercised safely.

Appendix 1 - Do you have any comments or concerns regarding the extension of the offence relating to dogs fouling on land, and, the requirements of anyone in control of a dog/s to pick up the poo and put it in a bin?

	Please detail your comments/ concerns below
12.	Well trained dogs should be allowed in most places except maybe children fenced play areas.
13.	There is no need to extend dog exclusion areas at all and for people with limited mobility or no transport it would become very difficult to give their dogs appropriate exercise.
14.	Too many exclusions.
15.	Too restrictive.
16.	Responsible dogs and owners should not be limited to where they can enjoy exercise. It greatly reduces our spaces. The amount of rubbish left behind by humans is far greater than by the minority of dog owners. The devastation following lock down has evidenced this. More poo bins and higher fines for those not adhering is enough.
17.	This is one of the only areas that is safe to take dogs in the local area where they can get the required amount of exercise and are not at threat or danger from cars on the roads. I have two springers and keeping them on a lead is detrimental to their health as they need to run for miles and this isn't possible whilst on a lead.
18.	As per previous comments. Dogs are the UK's favourite pet and legislation is in place that they are looked after correctly. For many not being allowed to stretch their legs and exercise properly will have a negative impact on their health and wellbeing, which is a contradiction of the welfare legislation. Walking my Labrador on pavements would not give him the amount of exercise he needs. We respect the other areas where we are no longer allowed to be off lead, please don't take this area away too.
19.	There is limited areas that we can walk our dogs and it's a nice area for responsible dog owners to walk their dogs and also for dogs to socialise.
20.	Why shouldn't dogs be able to use areas for exercise. What gives humans the right to dictate who and what should be able to exercise. It's a free world and dogs have as much right as others to exercise.
21.	This doesn't appear to be enforced.
22.	These should be extended especially on the seafront, why should dogs have the run of all of the seafront except for the one small area at Cleveleys.
23.	In America many of their public parks have fenced off areas where dogs are allowed to run free, away from the general public, with their owners present. Maybe this is something that could be looked for future plans? I know it's much easier to enforce laws in the states as their police are armed.
24.	Dogs should not be restricted. They are better behaved than humans.

Appendix 1 - Do you have any comments or concerns regarding the extension of the offence relating to dogs fouling on land, and, the requirements of anyone in control of a dog/s to pick up the poo and put it in a bin?

	Please detail your comments/ concerns below
25.	Depends if you are thinking of increasing more exclusion areas, as stated dogs need run play and exercise.
26.	Why in the Covid crisis where social distancing is so important would the council implement a rule that would force dog owners who wish to let their dogs off a lead be restricted to a confined area where the limited space would make social distancing impossible. The reason at the moment dog walkers go to the nature reserve is because it is safe for dogs to run free and the owners have enough space to keep a safe. There are very few areas that dogs are allowed off the lead and this restriction would be a blow to the local dog owners.
27.	This nature reserve has long been home to dog owners and dog walkers alike. The dogs love to meet to run and play together, this keeps them happy, keeps morale high, keeps them exercised.
28.	Again as above, there is no reason for dogs to be excluded from a place where they have been exercised without any problems for years.
29.	Why should my dog be excluded from areas that other reckless people can go and leave litter, drug litter, cans and bottles. Go on cotton Hall field about 8 .00 at night when the teenagers have been on there, the litter is terrible. My dog cannot leave that amount of litter!
30.	See specific comments regarding the changes at Fleetwood Nature Reserve and the Beach.
31.	This is a special place. Not a dog toilet
32.	It has clearly been proven that people are the issue leaving rubbish on the beaches and not the dogs. During covid the state the general public have left our proms and beaches is disgusting. Beaches are a great sensory play area for dogs and good for their health. I'm happy that during the summer months perhaps keep them on lead during prime hours 12-4 maybe. But when the beaches are quiet early morning and late afternoon they should be allowed to use the beaches provided any mess is picked up.
33.	There should be no exclusions except on sports fields.
34.	Why should my dog be excluded from areas that other reckless people can go and leave litter, drug Litter, cans and bottles. Go on cotton Hall field about 8 .00 at night when the teenagers have been on there the litter is terrible. My dog cannot leave that amount of litter!

Appendix 1 - Do you have any comments or concerns regarding the extension of the offence relating to dogs fouling on land, and, the requirements of anyone in control of a dog/s to pick up the poo and put it in a bin?

	Please detail your comments/ concerns below
35.	I support the proposal but would like to see the area expanded to the entire Fleetwood Nature Park.
36.	I believe that there is proposal to restrict allowing dogs off lead at Fleetwood Nature Park. I agree with this as the number of dogs exercised off lead here has resulted in marked reduction in ground nesting birds and also waterbird species. It is after all a nature park and used to be a great birdwatching site.
37.	I would like the authority to consider having seasonal lead orders, for example like the beach at Cleveleys this could be applied to Fleetwood Marsh which would protect the newly hatched birds and those adults/children who are brought by parents/ carers to feed the ducklings etc if they are nervous of dogs. My dogs need walking rain or shine the issue is non dog walking adults and children using the Marsh has been exacerbated by the nice weather and covid 19, usually on wet/ windy days it is only the hardened dogs walkers that you will see on the Marsh. My dogs have good recall however it would be difficult to keep them when off lead in the boundaries proposed without fencing, the authority could consider having a fenced area where children/adults are fully informed that there will be dogs off lead. I was diagnosed with Cardiomyopathy(enlarged heart) caused by a missed infection by medics 3 years ago and was under the care of Blackpool Victoria Hospital at this time we welcomed 2 dogs into our family I have walked daily (however at nearly 60 years I don't run) my young dogs need time to off lead and these proposed restrictions will make that very difficult for me to get the right balance of exercise for us all, 8 months ago I was discharged from the cardiac unit as my heart has returned to a normal size and this is directly due to my use of Fleetwood Marsh and Cleveleys and Rossall beach.
38.	I am firmly against dog exclusion areas as this prevents them from playing, socialising and learning how to behave with other dogs and new people. There is no justification for having dog exclusion areas just like there would be no excuse for having child exclusion areas.
39.	Areas to exercise dogs off lead are becoming few and far between. Dog owners get as much joy from seeing our pets running and playing with other dogs as parents do seeing their kids happy. I admit a minority of dog owners ruin it for the rest of us by not picking up after their pets or not muzzling dogs that can become aggressive. The majority of dogs and their owners get along just fine.
40.	There are already many places where dogs are banned in Fleetwood, including the beach. There needs to be somewhere where dogs can be allowed

Appendix 1 - Do you have any comments or concerns regarding the extension of the offence relating to dogs fouling on land, and, the requirements of anyone in control of a dog/s to pick up the poo and put it in a bin?

	Please detail your comments/ concerns below
41.	Dogs should be excluded from areas that are designated as Nature Reserves due to the disturbance and negative impact that they have on the wildlife. Dogs should be excluded from Rossall and Fleetwood Beaches April to September so that ground nesting waders can breed in peace without disturbance from dogs.
42.	I have concerns about the suggested use of dog exclusion areas at Fleetwood Marsh.
43.	Fleetwood Nature Reserve.
44.	I believe the council are trying to stop dog walking on the estuary because of complaints from cyclists who say there is an aggressive dog problem, this is not the case cyclists are the aggressor and they seem to think they own right of way, I to have been a cyclist and respect all people who enjoy the outdoor but if the council want to alienate 50% of their electorate this is not a good idea.
45.	That's fine but there should be more signs and it should be very clear. Unfortunately a lot of people don't seem to be aware of which parts this covers.
46.	Same as my comments below. If you were to fence certain areas this would limit the exercise areas. In the hot weather this is a place I bring my dogs to cool off and blow off steam.
47.	Clear signage to clearly show when a dog exclusion starts and finishes.
48.	As I previously said if you don't want dogs in certain areas then these areas must be cornered off with fences or gates, what a waste of time and money!
49.	Dogs must be allowed areas where they are free to exercise off the lead.
50.	I feel owners should be able to responsibly take their dogs on beaches for part of each day perhaps with a restriction between 10:00 to 18:00 on some beaches April to the end of September. Owners & dogs need to exercise freely for optimum health.
51.	Most of the beach is closed to dog owners from May to October and making further dog exclusion areas would further restrict where I can exercise my dogs.
52.	If the dogs are on leads it would not be a problem.
53.	Please see my previous comment.

Appendix 1 - Do you have any comments or concerns regarding the extension of the offence relating to dogs fouling on land, and, the requirements of anyone in control of a dog/s to pick up the poo and put it in a bin?

	Please detail your comments/ concerns below
54.	<p>I currently take my dog to the nature reserve at Fleetwood. I have been told of the new rules coming in to keep dogs on leads and stop them going into the water. I must add that there are no notices about these proposals which I think is a very devious way to obtain money from innocent dog owners. The majority of people pick up after their dogs and are careful to control their dogs when others are around. There is no where else to take dogs for a good run which is beneficial to their health and well-being and allow them to cool off in the water because of the restrictions on the beach. Maybe put some gates at each end to add some control and fence the ducks and swans nest at the bridge so that they stay on the side which dogs do not use. I feel very strongly about this and wonder what adequate alternatives will be provided by the council which will offer large spaces for dogs to run around and water to cool off if the proposals are enforced. Again, I think this is a money making opportunity for the council to try and catch people out as no notices are displayed about these proposals</p>
55.	<p>It's disheartening when I can't take dog on a deserted beach. Yet youths can drink alcohol, use drugs and leave all the rubbish including broken bottles behind. Also tourists think don't need to use bins and leave their rubbish behind including dirty nappies. Someone has to move it or will end up in the sea causing problems for wildlife.</p>
56.	<p>I am very concerned that dogs are being allowed to be exercised on public playing fields. I was annoyed that the owners of 3 dogs were using the football field at Preesall to exercise their dogs. Please could you put this in the restricted places that dogs are not allowed.</p>
57.	<p>It is possible and easy enough to clean up after them in areas where they are currently banned eg certain areas of the beach and the pitch n put.</p>

Appendix 1 - Do you have any comments or concerns regarding the extension of the offence relating to dogs fouling on land, and, the requirements of anyone in control of a dog/s to pick up the poo and put it in a bin?

	Please detail your comments/ concerns below
58.	I currently take my dog to the nature reserve at Fleetwood. I have been told of the new rules coming in to keep dogs on leads and stop them going into the water. I must add that there are no notices about these proposals which I think is a very devious way to obtain money from innocent dog owners. The majority of people pick up after their dogs and are careful to control their dogs when others are around. There is no where else to take dogs for a good run which is beneficial to their health and well-being and allow them to cool off in the water because of the restrictions on the beach. Maybe put some gates at each end to add some control and fence the ducks and swans nest at the bridge so that they stay on the side which dogs do not use. I feel very strongly about this and wonder what adequate alternatives will be provided by the council which will offer large spaces for dogs to run around and water to cool off if the proposals are enforced. Again, I think this is a money making opportunity for the council to try and catch people out as no notices are displayed about these proposals.
59.	Children’s play area, pitches, fenced areas no problem with. In other areas if you have a ban order then clear simple signage and markings on the paths etc need to be put in place. As a new dog owner I have no idea there is an order in place at Fleetwood estuary park.
60.	I feel that sports areas should be dog exclusion zones at all times.
61.	Why should dogs be excluded from any area? There is no good reason for this.
62.	Dogs need to be able to run off their energy to prevent aggression and to introduce socialisation. If you continue to reduce areas where dogs can be exercised off the lead, the areas left will become overcrowded with dogs creating even more problems. In particular Fleetwood promenade, Fleetwood picnic area and Fleetwood Nature reserve should be left as areas for dogs to run free. The part of the nature reserve requiring dogs to be put on a lead does not help to preserve wildlife, and makes no sense as dogs do not understand imaginary lines where they cannot run.
63.	I note that the dog exclusion areas are closest to the access and parking points of the facilities. This has the effect of restricting or even excluding those with mobility issues from exercising their dogs if they are unable to walk to the areas designated for dogs off leads.
64.	See above comment. Please don’t judge majority of responsible dog owners against a few who just don’t feel responsibility to clean up and make sure their dog is controlled.

Appendix 1 - Do you have any comments or concerns regarding the extension of the offence relating to dogs fouling on land, and, the requirements of anyone in control of a dog/s to pick up the poo and put it in a bin?

	Please detail your comments/ concerns below
65.	Children’s play areas have this order. I can understand why and whilst it does not affect me personally I can see that sometimes young families with dogs are forced to tie their dogs up outside the play area while they go in, or break the order and take the dog in. The only trouble with tying the dog up outside the area is that it can come loose and go running around the local park unsupervised causing more trouble than had the family been allowed to take the dog into the area on a lead.
66.	More enforcement required - dogs are regularly seen in the children's play area in Preesall.
67.	Please extend the number of exclusion zones particularly around beach and country side areas. Also restrictions on pavements.
68.	There are enough already...it is already extremely difficult to find open spaces to exercise a dog freely.
69.	Dog ownership provides companionship to many and an opportunity to visit local parks, beaches etc for exercise and meeting other like minded people. I believe all local parks and beaches should be open to all and patrolled if there is an issue.
70.	The area proposed is a common area for dogs to run off lead and restricts where they can be off lead massively. Plus it's going to be near impossible to stop them crossing from one area to another.
71.	People only use the beaches when the sun shines, dogs and owners use it 365 days a year regardless of weather.
72.	As above. Just because you don’t have dogs, you don’t get it.
73.	Excluding dogs from a nature reserve is absurd. I really feel the need to emphasise the importance of socialisation in order to prevent aggression and other poor behaviour traits. A vast majority of the owners are very attentive and all the dogs are incredibly well behaved. I see no reason why the council wish to enact measures which will simply ruin the ability for dogs to socialise and exercise together. Furthermore, the less open space available for individuals to walk dogs will undoubtedly lead to more cases of neglect and abandonment which is horrible to think about, but without the access to open spaces many families will be unable to exercise and socialise their dogs.
74.	I think all the beaches on the Fylde Coast should be permanently dog and horse free.

Appendix 1 - Do you have any comments or concerns regarding the extension of the offence relating to dogs fouling on land, and, the requirements of anyone in control of a dog/s to pick up the poo and put it in a bin?

	Please detail your comments/ concerns below
75.	Again for example at the Fleetwood nature reserve if you restrict areas that the dogs can be let off lead to exercise you are going to create problems by having nervous dogs and aggressive dogs pushed into a smaller area. At the moment the nature reserve is plenty big enough to avoid other dogs and owners. If there weren't so many restrictions everywhere else in the area then people wouldn't have to rely on the nature reserve so much to take their dogs out. Dogs need to exercise and the places and areas they are allowed to do so it's getting smaller every year. It's already difficult to enjoy a walk up there without having cyclists racing round as fast as they can and trying to avoid them and also trying to avoid families understandably. At the moment this is possible because of how big it is but if you restrict areas it's going to become much more difficult.
76.	The Fleetwood Nature reserve proposal is ridiculous. People will ignore anyhow or not be aware of it. That is the main part of the reserve. There is never that much wildlife there and would be better to insist on lead or on lead when requested. This area has been spoiled by too many dog walking companies exercising dogs here often meeting up so like a pack of dogs. I rarely go because of this reason. However it is a nice walk especially if extended towards the new estate and to Freeport.
77.	Find it remarkable that dogs are only excluded for part of the year. It should be none in my opinion. But either all the year or none of it.
78.	Please will you include Garstang TC's resolution from last night's TC meeting (17/8/20) in the consultation exercise 056(2020-21) Wyre Council " 3 Year Review of Public Spaces Protection Orders (PSPOs)" Control of Dogs and Dog Fouling, Cllrs Hynes and Webster Resolved: The Town Council approved Cllr Hynes comments: The High Street Riverside area is already marked down on the schedule, as a Dogs on lead area, which the TC feel is appropriate for this section of Garstang. Many families picnic here and in the summer is very popular with youngsters playing along the edge of the river. At the moment, many people are not adhering to this and dogs are not on leads and many a times have caused chaos amongst happy families enjoying their picnic, running into the river knocking children over and also attacking ducks. Signage is desperately needed to educate the owners that this a Dogs on lead area. I would suggest 3 signs would be needed -1 coming from the Millennium Green, and 2 either side between the carpark and duck area. Additionally, once the signs are in place, Garstang Town Council request that the signs are enforced and the dog fouling is addressed, by asking the enforcement officer to show his presence.
79.	It is not enforced!!! Extend by all means, but make sure the officers are there to enforce the order.
80.	For much the same reasons as above. The prevention of dogs entering the water is a huge concern and an animal welfare issue. Dogs do need some cooling off. Are people still going to be allowed to bathe? In twelve years I've not seen a dog hurt a bird in the

Appendix 1 - Do you have any comments or concerns regarding the extension of the offence relating to dogs fouling on land, and, the requirements of anyone in control of a dog/s to pick up the poo and put it in a bin?

	Please detail your comments/ concerns below
	pond, but I've seen youths and children, under the supervision of adults, throwing stones at ducks.
81.	The area of dog exclusion in Cleveleys is large. Could this be reduced to allow dog walking on lead to the Blackpool Boundary from Victoria Road? But keep dog exclusion zone in place to Cafe Cove? This would mean dogs and their owners would need to come off the beach at Victoria Road.

Appendix 1 - Do you have any comments or concerns regarding the extension of the offence relating to dogs fouling on land, and, the requirements of anyone in control of a dog/s to pick up the poo and put it in a bin?

A5

	Please provide comments - Please provide any comments/reasons below.
1.	I agree should be available for all.
2.	Requirement there may be but it is ignored wholesale. Try strimming or mowing these areas, it alters ones perspective.
3.	My observation is that people exercising dogs on playing fields frequently let their dogs off their leashes-and in such circumstances, definitely do NOT pick up after their dogs. Is it fair that whoever then uses the field for a game or other activity should have to contend with the subsequent fouling.
4.	A dog walking space should not be in areas where regular activity takes place by our young people. It is not always possible to pick up all traces of dog poo plus dogs will also urinate in these spaces making them unhygienic for any kind of sport.
5.	I can certainly see why dogs should be allowed when the pitches aren't in use, but again, people are the problem. There are still those that don't pick up after their dog, and if someone fell into this during a match it could be devastating.
6.	My observation is that people exercising dogs on playing fields frequently let their dogs off their leashes-and in such circumstances, definitely do NOT pick up after their dogs. Is it fair that whoever then uses the field for a game or other activity should have to contend with the subsequent fouling.
7.	As the council well knows, there is no existing enforcement of exclusion zones nor of fouling. A lot of dog owners simply ignore these orders and will do so on sports pitches, where it is often impossible to see dog waste and where more children will be exposed to it.
8.	There are plenty of places to exercise our dogs other than on sports pitches.
9.	Have visible enforcement officers out checking that dog owners abide by the bylaws.
10.	Again an irresponsible few never tidy up, dogs can not read, and children will break rules and need protection from unruly dogs, poor dog owners, if they take advantage of these sports areas when not in season or usage.
11.	Too many people failing to pick up dog poo, example Thornton rugby pitch is repeatedly soiled.
12.	It is what is left behind that matters not whether or not the areas are in use. They should be in the inclusion zone.
13.	The marked sports pitches near me are never enforced and there are plenty of dogs being walked on them during the times or organised activity, so allowing them when no organised activity taking place could muddy the waters.

Appendix 1 - Do you have any comments or concerns regarding the extension of the offence relating to dogs fouling on land, and, the requirements of anyone in control of a dog/s to pick up the poo and put it in a bin?

	Please provide comments - Please provide any comments/reasons below.
14.	There is no issue in dogs being exercised when the sports pitches are not in use.
15.	There is no reason why responsible dog owners shouldn't be allowed to use unfenced spaces when not in use. There should be punishment of some sort for irresponsible dog owners though as they spoil it for others.
16.	If you allow dogs to be exercised on a pitch this will increase the problem, as they will be exercised regardless of whether there is an organised event or not.
17.	More multi-purpose bins will be needed. The South Strand entrance bin (very small) at King Georges playing fields in Fleetwood, is regularly overflowing. We regularly pick up litter there - left around the pitch perimeter area. Broadwater entrance has a large bin, one of those on either side of field would help.
18.	I think dogs should continue to be off limits whether fenced or not as unfortunately there are a minority that allow their dogs to foul and don't pick up after them.
19.	Providing people remove faeces I see no problem probably less risk of contagion than from footballers spit.
20.	Dogs need off lead exercise every day.
21.	People may pick up after their dog but some faeces will still remain and there is the possibility of worms from untreated dogs. Children then roll on the grass that has been used for urine as well. Allowing dogs on even when owners pick up encourages other less responsible owners to also allow their dogs to foul the area.
22.	As long as the owners clean up after their dogs I see no reason for them to be exercised on marked sports pitches when not in use.
23.	More enforcement is needed and good publication of fines issued.
24.	Hambleton have an enclosed area for the exercising of dogs, this works really well & am sure could be replicated in Poulton, Thornton & Fleetwood. I agree that unfortunately some dog owners and disreputable dog walkers have spoilt it for the majority of sensible owners However there must be a workable solution, whether it be a fenced off area or certain times of the day where dogs can be off lead. A blanket restriction will be unworkable and will only move any problems to other areas.
25.	Residual mess is a hazard and not all dog walkers pick up.
26.	Our dogs love going there they are all behaved and they play and come back when called.
27.	If the current restrictions are not enforced then why would these changes be? Dog poo in areas where children play is unacceptable.

Appendix 1 - Do you have any comments or concerns regarding the extension of the offence relating to dogs fouling on land, and, the requirements of anyone in control of a dog/s to pick up the poo and put it in a bin?

	Please provide comments - Please provide any comments/reasons below.
28.	Dog faeces carries disease and worm eggs even when picked up residue can remain in grass this is a public health hazard. Children would like to exercise and play in these areas but cannot do so safely if dogs are allowed to roam free.
29.	Allowing dogs to use marked areas when organised activities are not taking place does not remove the hazard of excrements both urine and faeces being left on pitches that are to be used for sport at a later date.
30.	Logical amendment in line with most LAs.
31.	As long as you're cleaning up after your dog and being responsible with it, I feel you should be able to exercise your animal in all open spaces.
32.	This sounds great.
33.	Yes, common sense.
34.	All residents pay for these spaces and should be allowed to use them responsibly.
35.	Yes I agree with this and I think most dog walkers do.
36.	I think in certain areas it would be better to install CCTV to police the fact that only one or two individuals do not collect their dogs waste. It seems very 'big brother' to stop the majority of individuals who abide by the rules from exercising their dogs; which sometimes if not exercised enough could become a danger to children/families and others.
37.	Dog mess is a mess at all times. When children go there it is a danger to their and all our health.
38.	I totally understand about the need to have dogs on a lead in certain areas, however, I have not got a large garden and my dogs love been able to run free. My local area (Winmarleigh hall) was fantastic for this as my children could play in the park and I could play with the dogs in an enclosed safe area. But now unfortunately due to certain people who let their dogs foul and just leave it (mainly an elderly gentleman with a chocolate Labrador, who I've had words with many times about this) we can no longer let our dogs off the lead which I'm so upset about. Responsible dog owners need somewhere where they can exercise their dogs but also where it is safe to do so please resolve this issue, do not punish all dogs just because there is some irresponsible people out there.
39.	Should not be allowed on at all. Not fair on kids wanting to use them if dogs are running on them.
40.	Yes I agree with this and I think most dog walkers do.

Appendix 1 - Do you have any comments or concerns regarding the extension of the offence relating to dogs fouling on land, and, the requirements of anyone in control of a dog/s to pick up the poo and put it in a bin?

	Please provide comments - Please provide any comments/reasons below.
41.	Dogs should be excluded from sport fields at all times. Some owners will not remove faeces. While unused sports pitches often provide valuable feeding and roosting areas for many birds. Dogs prevent such use by birds.
42.	Litter bins need to be provided and notices stressing they are sports areas.
43.	As a responsible dog owner I would clear up after my dogs and ensure they are wormed regularly as prescribed by their vet.
44.	I think responsible dog owner should be able to use Sports pitches when they're not in use as we are fast running out of areas to exercise our dogs due to all the new homes being built
45.	It is hard to find places to exercise dogs off lead, so it is important that there are not too many restrictions. However when a place like this is being used for an event dogs should be on leads.
46.	It is a shame people are not respectful to others and leave foul behind.
47.	I never walk my dog over a marked pitch anyway as even if you pick up after your dog there could still be residue left. I walk around the outside of the pitch and if there were a match on, I would go elsewhere.
48.	Dogs should only be exercised off the lead in fenced areas.
49.	Dogs should be excluded at all times. Many dog owners do not pick up after their dogs leaving the faeces for authorised users of the pitches to tread in and / or contaminate their skin and clothing.
50.	Not all Dog owners pick up which makes the open green unusable for everyone.
51.	It seems wasteful not to use the fields when no organised activity is going on so I think it should be available for dog walking.
52.	I walk my 2 dogs on these grounds every day nearly. I see the same dogs, same families and all dogs are loving life, enjoying their walk. It's very rare I see any dogs on leads on there! If this comes into place it will ruin a public social happy face for families and the dogs are not going to enjoy their walks when walking along their owners. My 2 dogs are very behaved. In 3 years of going to the nature reserve I've never seen a dog misbehave. I personally think it shouldn't be frowned upon at all and if I'm honest if you're not happy with it then don't go on there. Dogs have nowhere they run and play, beaches, no. Parks? No. Please don't ruin this beautiful place.
53.	Very welcome change and one which I had planned to suggest.

Appendix 1 - Do you have any comments or concerns regarding the extension of the offence relating to dogs fouling on land, and, the requirements of anyone in control of a dog/s to pick up the poo and put it in a bin?

	Please provide comments - Please provide any comments/reasons below.
54.	There is lots of large green space in Fleetwood such as the pitch and putt by the kite shop. This area is a dog exclusion zone, however most of the year it isn't used. And it's rarely used early in the morning, it would be an ideal place to walk a dog and I would much rather this land be available rather than used as an exclusion zone due to the occasional golfer on it for three months of the year.
55.	Lots of people don't pick it up so dogs shouldn't be on there.
56.	I agree to allow dogs on the excluded areas when the pitch isn't in use as it isn't being used therefore it makes sense to benefit some people, and then when the pitch is in use again then make it inaccessible for dogs. It could be an idea to insert temporary bins on the pitch when it isn't in use to encourage dog walkers to pick up dog litter and use the bins provided and then removed the bins when the pitch is being used again.
57.	Clear signage.
58.	As long as people pickup after their dogs, what's the problem?
59.	Many people take their dogs to watch local sporting events and provided they are under control, what harm is there?
60.	Even when owners do pick up after their dogs, the area remains soiled. Pitches cannot be cleaned before use for sports.
61.	See previous comments. Do not think dogs should be allowed on children's /adults playing fields or parks. Some owners are unreliable re picking dog poo up as we well know from walking along the sea wall at Knott End!!
62.	Catterall Parish Council has built more play areas since the last consultation and these must be included. Map included.
63.	As long as the signage is clear
64.	Need to exercise our dogs. Most do no harm and enjoy off lead time to socialise with other dogs.
65.	It is difficult to tell where a dog has left its mark if it is allowed to run off a lead. Furthermore, whether on a lead or not all dog walkers cannot be trusted to pick up after their dogs. Sports pitches must be left for whom they are intended, without the risk of encountering dog mess which could lead to serious health implications.
66.	Dogs should not be allowed on sports pitches at any time.
67.	As long as the signage is clear
68.	As long as people pick up after I can't see why this is an issue.

Appendix 1 - Do you have any comments or concerns regarding the extension of the offence relating to dogs fouling on land, and, the requirements of anyone in control of a dog/s to pick up the poo and put it in a bin?

	Please provide comments - Please provide any comments/reasons below.
69.	Happy to do this. It's irresponsible dog owners who are the problem covering all ages.
70.	What change? I agree with the policy allowing dogs to be exercised on playing fields when they are not in use, and not want this to be changed.
71.	I welcome this. It permits dog exercising in areas with easier access for limited mobility dog owners.
72.	Let's utilise land when not in use.
73.	It seems fair that when an activity is not in place the area can be used to exercise dogs as long as the owners pick up after their dogs. It would also be useful to encourage an informal "code" whereby should people come on to use say a football field for a kickabout any dog owners exercising their dogs would voluntarily relinquish the field and move to another area of the park. This is mainly what happens in North Drive Park. Because of the campaigning that was done in 2009 for this area (supported by Cllr Kay) it's almost become custom and practice that most (not all) dogs do this and move to the smaller area adjacent. I would like to see this continue and the above order seems to include this and be the most sensible option.
74.	Signs needed, dogs only to be exercised on pitches when not in use. Don't forget dog walkers are rate payers too.
75.	I feel that sports areas should be dog exclusion zones at all times.
76.	I feel dogs should be excluded from sports pitches.
77.	Sadly owners cannot be relied upon to follow the rules. Clear simple rule - no dogs.
78.	I think the pitches should be dog free at any time as there are irresponsible dog owners and it is likely before any match, a match official or parent of the players would have to search the pitch to check it was foul free and they should have to as it is often young people who use these pitches.
79.	The vast pitch and putt areas running from the Mount to the boating lake are very under used and would provide ideal dog exercising space. Maybe consider one side of it is turned over to dog walkers permanently? More education and bins for the few that still can't be bothered to pick the dog mess up.
80.	So long as owners are responsible in picking up after their dog, there is no harm in the dogs using the open space for exercise when organised sport is not taking place. This is especially apparent in the winter months when little sport takes place however dogs still need to be exercised.
81.	Marked sports pitches must be out of bounds to dogs at all times.

Appendix 1 - Do you have any comments or concerns regarding the extension of the offence relating to dogs fouling on land, and, the requirements of anyone in control of a dog/s to pick up the poo and put it in a bin?

	Please provide comments - Please provide any comments/reasons below.
82.	I agree with the proposed change because I live directly opposite a sports field and I do not own a dog but sometimes care for my daughters and my opposite field while widely used by dog walkers to my knowledge is poo free. There is a bin which is emptied daily by WBC.
83.	Not everyone picks up after their dogs, I don't see why responsible people who play sports should be inconvenienced by dog mess left by the ignorant few.
84.	Of course if there are pitches in use then dogs should not be allowed on them but otherwise it's a shame that the fields can't be enjoyed by everyone. Target the dog owners that do not pick up after their dogs instead of banning everyone else from using them. Again there is limited places we can exercise dogs so to allow owners to use the pitches while not in use would be a help and a positive step to show dog owners that you are not anti-dog in Wyre.
85.	I think sports pitches should be kept free of dogs.
86.	NO! Dogs should not be allowed on these pitches at any time. Not all owners clear up. It doesn't matter how many warnings you give these people, they just ignore them. How disgusting is to turn up for a game of football only to find dog faeces on the pitch!
87.	It would be preferable for dogs to be kept on leads at all times. It's OK having signs up, but dogs running loose who go in longer grass cannot always be seen and the owner doesn't pick up. If they are on a lead - could be extending - then they are under control.
88.	Will those areas be examined prior to each usage?
89.	To enable dog walkers to exercise in these large spaces. However the enforcement on dog fouling would need to be strict to ensure the pitches are not fouled. Could the dogs be required to go on lead on request?

Appendix 1 - Do you have any comments or concerns regarding the extension of the offence relating to dogs fouling on land, and, the requirements of anyone in control of a dog/s to pick up the poo and put it in a bin?

A6

	Please provide comments - Please provide any comments/reasons below.
1.	The beaches are deserted by everyone other than dog walkers outside of the summer season.
2.	I don't have a problem with dogs being exercising on the beaches during winter when people are not sitting on the beach or bathing.
3.	Clear signage is required especially over the bridge between the 2 boating lakes in Fleetwood stating no swimming at any time. A visitor from Manchester has already had a very nasty accident jumping from the concrete pipe into the sea which has left him eating through a straw. Myself (Cllr Fairbanks) and Cllr George have both checked this area and noted no signage was there at all warning people not to swim in that area of the beach.
4.	I cannot understand the reasons behind banning dogs from the main stretch of Cleveleys beach. I have never come across a problem with regards to dogs on the beach, even with my two preschool children in tow. I haven't come across dog muck either. The only problems I have come across have been concerning humans, namely rubbish and antisocial behaviour. Dogs aren't the problem, people are.
5.	I don't have a problem with dogs being exercising on the beaches during winter when people are not sitting on the beach or bathing.
6.	The current ban is ignored. A year-round ban would remove any ambivalence.
7.	Only really dog walkers out of season.
8.	The period is already too long.
9.	Hardly any tourists in winter. Locals should have priority and in bad weather it's empty apart from those of us who are dedicated.
10.	The beaches certainly in Fleetwood where I live are very quiet in the winter, why not let people on with their dogs? They do no harm and gives a wider area to exercise.
11.	Enforce against the 2% of idiots who don't clean up after their dogs, not the 98% of dogs who don't understand or deserve to be punished.
12.	During the season makes sense as it is busier but not during the winter months when bathing isn't taking place.
13.	A great deal of investment has taken place over the last few years, with the result we now have a clean beach and starting to get safe bathing water. Extending and enforcing the ban on dogs will only enhance the cleanliness of the beach and get dog owners use to avoiding the parts of the beach that are prohibited to dogs.

Appendix 1 - Do you have any comments or concerns regarding the extension of the offence relating to dogs fouling on land, and, the requirements of anyone in control of a dog/s to pick up the poo and put it in a bin?

	Please provide comments - Please provide any comments/reasons below.
14.	Once again I find uncontrollable dogs coming into my personal space frightening, so do others I surmise. If any mess is deposited it seems to be left behind.
15.	It's a small area of what is a long stretch. The exclusion should apply all year.
16.	There is reduced beach use in winter months and hence people can exercise their dogs closer to where they live in a safe manner.
17.	No reason why we can't exercise our dogs in these areas during the off season months.
18.	There are fewer people about making use of the beach in the winter so I don't feel it should be applied all year round.
19.	No because there's too many places we can't take our dogs as it is. I can't physically do two dog walks per day and have 5 dogs. Dogs need to exercise or it causes bigger problems! Humans are more disgusting, fine them not innocent dog owners trying to walk their dogs on the beaches.
20.	Although I rarely see if it enforced.
21.	I live on the Promenade at Rossall and feel it is of benefit for my dog to be able to go on the beach for walks when it's off season and not many people around.
22.	Absolutely not. There are very few fields and no wooded areas at all due to the area we live in, there is no evidence to support a year round ban, the quality of water is not affected, in fact it is impossible to test for dog faeces, given the amount of run off from farms and waste pumped into the sea, dog waste is minuscule.
23.	If the bathing beaches are not being used for such a purpose during the winter months, it is unreasonable to prevent dog walkers from using them.
24.	Seasonal is quite enough.
25.	People need place to exercise their dogs.
26.	Families can often be seen playing in the sand even in winter.
27.	Only in summer.
28.	Out of season these beaches are deserted and dog walkers are entitled to use and enjoy the space like everyone else.

Appendix 1 - Do you have any comments or concerns regarding the extension of the offence relating to dogs fouling on land, and, the requirements of anyone in control of a dog/s to pick up the poo and put it in a bin?

	Please provide comments - Please provide any comments/reasons below.
29.	If this is applied all year round then the amount of places to take your dog to exercises is beyond limited. It is unfair on those people who don't have cars but still want to care for their pet properly and ensure they get the exercise required. Having a dog is a great help with human mental wellbeing and restricting where you can take them will result in more lazy people not getting out with their animals or animals being disregarded and neglected. It is unfair.
30.	People don't use the beach all year round for recreation, so why shouldn't the dogs be able to go on in winter?!!
31.	It would appear unfair to ban this all year round, when in the autumn and winter months the only people who frequent this area are dog walkers in the main.
32.	These areas should be extended we need more dog free areas for children to play safely.
33.	Beaches largely deserted outside the summer season.
34.	Most dog walkers leave less mess on beaches than the public & fishermen, yet dog walkers are the group that is penalized. We should promote Wyre as dog friendly in order to bring in tourism, not drive dog owners away.
35.	Again - dogs should not be banned from anywhere. They are family members and should be treated like this.
36.	I actually think fishermen are far more of a nuisance than dogs. If you have a well behaved dog they will stay away from other if you are a responsible owner and keep your dog in your eye site all the time.
37.	Not at all! It's unfair!
38.	Responsible dog owners should be allowed to exercise their dogs at least during certain periods.
39.	The beach is a large area in the summer I can understand there is more families etc but in the off season there is no need at all to exclude dogs.
40.	Children do not generally play on the beach in winter.
41.	We are already restricted to where we are allowed to exercise our dogs we feel as locals we should be able to exercise them on our local beaches at least out of season.

Appendix 1 - Do you have any comments or concerns regarding the extension of the offence relating to dogs fouling on land, and, the requirements of anyone in control of a dog/s to pick up the poo and put it in a bin?

	Please provide comments - Please provide any comments/reasons below.
42.	Many families choose to take their children and dogs to the beach to enjoy family time. You risk excluding many families by imposing this ban. We already can't enjoy the beach like others can during the warmer summer months, there is no reason to take the winter months from us too. In my experience dog owners leave pretty much zero waste whilst families with small children leave food wrappers, nappies, and other waste behind them on the beach. I'd actually argue they are a danger to any dogs and would much rather they litterers be banned than dog owners.
43.	I don't agree with the ban at all for dogs on beaches. If you look at the number of people who walk dogs in the areas it would be better if dogs are walked on beaches rather than promenades. Most responsible dog owners pick up after their dog, more needs to be done about irresponsible owners, more wardens on patrol.
44.	Locals and tourists leave more litter in a day then any dog can in its lifetime! Dirty nappies, food, cans, bottles etc!
45.	Shorebirds are harassed by dogs along the entire Wyre coastline. There is an important roost site on the beach at Rossall Point and Ringed Plovers attempt to nest here. A section on beach 300 yards each side of the Rossall Tower should be designated dog free year round. My experience here is that the bird flock is disturbed an average of every 15 minutes by dogs.
46.	Both are quiet out of season.
47.	I should remain seasonal as the beaches are deserted in late autumn/ winter and early spring.
48.	Dog owners do need spaces to exercise their dogs and in the winter months it seems reasonable to allow them on the beach.
49.	There are nesting birds in the shingle at Rossall and VERY rare plants including sea kale and yellow horned poppy in this area. Plus the biological database habitat species of honeycomb worm on the grounds. These are should be top priority if we are to protect our biodiversity.

Appendix 1 - Do you have any comments or concerns regarding the extension of the offence relating to dogs fouling on land, and, the requirements of anyone in control of a dog/s to pick up the poo and put it in a bin?

	Please provide comments - Please provide any comments/reasons below.
50.	It has clearly been proven that people are the issue leaving rubbish on the beaches and not the dogs. During covid the state the general public have left our proms and beaches is disgusting. Beaches are a great sensory play area for dogs and good for their health. I'm happy that during the summer months perhaps keep them on lead during prime hours 12-4 maybe. But when the beaches are quiet early morning and late afternoon they should be allowed to use the beaches provided any mess is picked up. Beaches are public spaces and should be allowed to be used as desired. Having a small child and a dog (dogs are also for life) it is increasing hard to find places we can go out together as dogs are not allowed in parks. It is unfair to leave the dog at home or alternatively our child miss opportunities of using public spaces. Maybe look at investing into dogs in the community rather than constantly taking away facilities and dining. We would happily pay £1 an hour to use an area which is fun and enjoyable for all our family.
51.	I regularly walk to the beach around the Observation Tower area, this area is often used by nesting seabirds and would benefit from limited access at certain times of the year as the dogs are off lead and disturbing the young birds. Also the flocks of Waders that winter here are constantly under attack from out of control dogs, in fact one individual who has two "Pointer" Dogs and uses the beach here most days actually encourages her dogs to chase the grounded flocks all along the shoreline!
52.	As I said previously it is hard to find suitable places to walk dogs off lead, also some owners may go very early or at night and the restrictions would still affect them. Dogs as well should not be penalised for some owners not picking up their poo and other humans on the beach seem to leave a lot of rubbish behind too.
53.	Plenty of other areas to walk a dog. Some areas should always be kept safe and dog free.
54.	Only when people are using it. I disagree with dogs being allowed to go near young children. Many people can't control their dogs.
55.	I fully support the ban during the summer but see no need for this during the winter months. The beach is probably used by more dog walkers than non-dog walkers in the winter.
56.	Yes, but ONLY so that it is easier followed. I have often visited the beach with my dog later in the evenings and taken him on the beach without seeing the signs until leaving. If I knew they were permanently banned, it would not confuse me and other owners. There should perhaps be signage to show that "this beach" cannot be used and it should detail the nearest beach that dogs can be walked on. This would guide me and other owners to a beach that is safe to walk our dogs.
57.	If people are not bathing, I don't see why the dogs can't enjoy the space. However, as long as owners pick up the foul.

Appendix 1 - Do you have any comments or concerns regarding the extension of the offence relating to dogs fouling on land, and, the requirements of anyone in control of a dog/s to pick up the poo and put it in a bin?

	Please provide comments - Please provide any comments/reasons below.
58.	There is simply no need and where do you want responsible dog owners to exercise their dogs?
59.	The beaches are mainly used by dog walkers once the summer season is over. I understand limiting the areas dogs can go on during the summer months though. Sadly it is people/fishermen who leave most of the rubbish on our beaches not dogs.
60.	Dogs aren't the problem, people are. People leave litter, fishermen leave hooks and wire.
61.	There is no need out of season when the beaches are deserted apart from dog walkers and horse riders.
62.	But there should still be a policing of the area.
63.	The beach is mainly used by dog walkers out of season so it is overly restrictive to apply the ban all year round. The beach would hardly be used if that was the case.
64.	There should be areas where people don't have to put up with dogs.
65.	It is a beauty spot that people enjoy, why can't our pets enjoy it as well?
66.	Absolutely not!!! The evidence is clear that dogs are not the main cause of issues on the beach relating to litter and mess. The state of the beaches in warmer days is an absolute disgrace with the amount of rubbish that is left behind. The bins are often overflowing which needs addressing.
67.	There is more rubbish left on the beach by visitors than dog walkers. We need somewhere to exercise our dogs.
68.	I walk my dogs on the beach most days, I have no problem in not walking them on the small portion of the beach where they are not allowed. Some people do not like dogs and there should be an area where they can go and use the beaches without fear of being molested by dogs, any responsible dog owner should agree with this - being a "responsible dog owner" is more than just picking up your dog's poo, it is also about good interaction with other people.
69.	I feel owners should be able to responsibly take their dogs on beaches for part of each day perhaps with a restriction between 10:00 to 18:00 on some beaches April to the end of September. Owners & dogs need to exercise freely for optimum health.
70.	Why for goodness sake? There is no-one on the beaches during the winter so exercising dogs anywhere just isn't an issue! Besides, during the summer, humans leave more waste and rubbish on the beach or near by than any dog!
71.	When people aren't bathing there's no point in restriction.

Appendix 1 - Do you have any comments or concerns regarding the extension of the offence relating to dogs fouling on land, and, the requirements of anyone in control of a dog/s to pick up the poo and put it in a bin?

	Please provide comments - Please provide any comments/reasons below.
72.	The beaches are rarely used for bathing anyway, and whilst I think it's appropriate to have an area where families can be undisturbed by dogs during the summer months, the area wouldn't be used in the winter months, so seems pointless to exclude dogs year round.
73.	Dog excrement is a pollutant all year round.
74.	These areas are important wintering areas for waders, and this will help to reduce disturbance particularly at high tide when they are roosting. What some people don't realise is that at high tide these birds cannot feed because their feeding areas are covered by the tide, and therefore they are forced to roost over the high tide period. If these birds are disturbed whilst roosting this forces them to fly and use up valuable fat reserves, and this can be the difference between surviving or not surviving the winter.
75.	It shouldn't apply at any time as most dogs and owners are more responsible than gangs of teenagers and some day trippers who leave litter everywhere
76.	Why would you want to bath in the colder months?? England hardly has weather to spend a day at the beach to bath and swim. If you was to provide an area like a dogs park on the beach that would resolve issues. Dogs love to feel the cold wet sand on their feet and the run in the sea. A dog is no different to letting a child play and swim on the beach.
77.	It would be far cheaper to provide a box with poo bags.
78.	There is not an need for an all year ban when people are not using the beach during the colder months for bathing.
79.	The beaches are poorly utilised even during peak periods. Limiting access out of season does not make any sense at all.
80.	Absolutely ridiculous idea!! We are a nation of animal lovers and it is ludicrous to suggest an all year ban. What are families supposed to do if they have a dog...leave it at home or worse a hot car!!!
81.	It is very important that dog owners have access to beaches for exercise for dogs and owners. The current ban period is a lengthy one and dogs are only allowed in these areas at times of the year when the weather is often so inclement you cannot go to the beach anyway. I think the current seasonal ban is more than sufficient.
82.	It's dead 6 months of the year. Why not allow local dog walkers to enjoy their town's beauty spots.
83.	Unreliable dog owners.

Appendix 1 - Do you have any comments or concerns regarding the extension of the offence relating to dogs fouling on land, and, the requirements of anyone in control of a dog/s to pick up the poo and put it in a bin?

	Please provide comments - Please provide any comments/reasons below.
84.	The beaches in question are rarely used in the winter months and as long as dog owners pick up after their dogs I see no reason to extend these restrictions. There is far more litter and mess left by holidaymakers using the beach in the summer months - including human excrement!!
85.	Why when only locals use it to exercise our dogs? They enjoy off lead time to socialise with other dogs.
86.	Absolutely ridiculous!!!!
87.	Absolutely not. I already don't agree with banning dogs in summer - it would be completely unreasonable to ban them all year round, even when people won't be bathing.
88.	The beaches are only ever used when the sun is shinning, we walk our dogs 365 days a year and I feel the dogs have just as much right on the beach. The biggest problem that really needs addressing is irresponsible owners that don't pick up after the dogs, and yes that is still a lot and I get so mad ? because it gives us responsible owners a bad name.
89.	The bathing beaches are empty during the winter months so dogs should be allowed on them.
90.	No, remain seasonal.
91.	Simple rule. People are not following the current restrictions.
92.	Out of season the bathing use is minimal.
93.	Banning dogs from the beaches all year round is simply wrong. In the winter months the beaches are not used by anyone apart from people who are exercising their dogs, therefore what is the harm in the dogs enjoying the open space and socialising? There is no harm. During the winter months dogs should have access to all beaches to play and exercise.
94.	In the winter there are far fewer children using the beach, so I guess it's less of a problem.
95.	Beaches out of season are often quiet and provide excellent exercise areas for dogs. Wind and rain may deter bathers but rarely deter dog walkers.
96.	I think the Council have the current banned period about right. Enforcement is the requirement.
97.	These beaches are normally deserted from October to April except for mainly responsible dog walkers. Why penalise them.
98.	People should be allowed to walk their dogs on the beach when it is quiet, provided they keep their dog on a lead if there are other people on the beach.

Appendix 1 - Do you have any comments or concerns regarding the extension of the offence relating to dogs fouling on land, and, the requirements of anyone in control of a dog/s to pick up the poo and put it in a bin?

	Please provide comments - Please provide any comments/reasons below.
99.	Even during the winter children still go on the beach either from school to do a project or of the weather is fine they will go on the beach to play after school
100.	My granddaughter is frightened of dogs and when last on the beach a large uncontrolled dog came charging towards her and nearly knocked her over, as usual with dog owners they assumed everybody likes dogs and said it was very friendly and only wanted to play.
101.	Dogs need exercise and the short section of Fleetwood beach where they are allowed is pretty poor for running them with a ball etc. there's only a short section of sand when the tide is out and this is often occupied by kite flyers and sand buggies, also families setting up for the day when there are ample open spaces on the other side of the beach, some sort of notice advising that it is a dog friendly section may be helpful. Opening up the other part of the beach out of season is welcomed for a decent walk and exercising area, the dog mess does seem to be minimal on the beach.
102.	Only necessary when very busy during holiday season.
103.	I walked my dogs on these beaches for at least 30 years and have no objection to avoid humans in holiday season and there are very few of them about for the rest of the year apart from other dog walkers and anglers braving the elements...so what is the problem? No need to change this in my opinion.
104.	The beach is not used for sitting on during this time, therefore could be walked.
105.	Most walkers in these areas do so responsibly ... the enforcement at others times would cost money, whilst removing council Enforcement officers from far more urgent employment and therefore any extra times of the ban expensive as well as unnecessary .
106.	I think all the beaches on the Fylde Coast should be permanently dog and horse free.
107.	In winter there is nobody on the beaches apart from dog walkers. Why shouldn't dog owners use all the space to exercise their dogs without causing any problems to anyone when there are already so little places we can go? Even in the summer months dogs should be allowed on the beach but kept on the lead. This would bring in a lot more families to the area that own dogs and therefore bring in a lot more income because at the moment families with dogs stay away because of the restrictions. I wish Wyre could be more like Cornwall and Cumbria where dogs are allowed in more areas under control because it would create a lot more revenue for the area and allow people to enjoy the coastline that we have. Of course target those that break the rules but please don't target everyone. Humans leave a lot more mess on the beaches and the nature reserve than any dog walker I have ever known.

Appendix 1 - Do you have any comments or concerns regarding the extension of the offence relating to dogs fouling on land, and, the requirements of anyone in control of a dog/s to pick up the poo and put it in a bin?

	Please provide comments - Please provide any comments/reasons below.
108.	No way! Realistically how many people actually swim in the sea here? It's far too dangerous most of the year. The beach at Marine Hall has gone awful, very pebbly and both areas (Cleveleys) have areas of sinking mud. Please do not penalise responsible dog walkers by banning dogs on these beaches out of season. Come on who is going to go bathing Oct-Mar/April? It's usually blowing a gale down on the beach and its only us dog walkers who are venturing out.
109.	Find it remarkable that dogs are only excluded for part of the year. It should be none in my opinion. But either all the year or none of it.
110.	To enable people to use the beach with the dogs however the dog should be on lead to ensure they are under control.

Appendix 1 - Do you have any comments or concerns regarding the extension of the offence relating to dogs fouling on land, and, the requirements of anyone in control of a dog/s to pick up the poo and put it in a bin?

A7

	Please provide comments - Please provide any comments/reasons below.
1.	There are rarely any families on the beach outside of those times. Tend to be dog walkers only.
2.	As most people don't even observe the dog ban anyway, I doubt they'd observe the time restrictions either. Once again-yes, it needs to be enforced!
3.	These areas must be provided with suitable life guards during the above times with clear signage warning people not to swim outside of the above dates/times.
4.	I cannot understand the reasons behind banning dogs from the main stretch of Cleveleys beach. I have never come across a problem with regards to dogs on the beach, even with my two preschool children in tow. I haven't come across dog muck either. The only problems I have come across have been concerning humans, namely rubbish and antisocial behaviour. Dogs aren't the problem, people are.
5.	All year application needed.
6.	Time limits as indicated would be welcomed.
7.	I think it's good to have specific areas as there are people who can't control their dogs, not good for families on the beach with small children.
8.	A time frame would be better but this may cause confusion for some. You would also be relying on them being responsible dog owners before 10am visiting the beach and picking up after their dog. A blanket ban does work best for the season to avoid confusion and excuses.
9.	It's a small area of what is a long stretch. The exclusion should apply all year.
10	This would seem a fair compromise.
11	We could then enjoy the evening weather in the summer months in those places.
12	Holiday makers are usually using the beach during the day, no need for the ban very early morn or later evening.
13	Yes as it's nice to have some areas that are dog free.
14	Think that's a great idea.
15	The beaches are empty in the early mornings and evenings so dog walkers aren't bothering anyone walking at that time.
16	Not enough space or places to take 5 dogs as it is.

Appendix 1 - Do you have any comments or concerns regarding the extension of the offence relating to dogs fouling on land, and, the requirements of anyone in control of a dog/s to pick up the poo and put it in a bin?

	Please provide comments - Please provide any comments/reasons below.
17	As long as a dog is on lead in the summer season I don't feel it is a problem.
18	No beach ban is necessary seasonal or otherwise, look how much waste is left by humans in comparison.
19	It is unlikely that the bathing beaches will be used for this purpose during the out of season period.
20	It would be fair to all.
21	I don't think there should be a ban at all as long as people exercising their dogs are responsible.
22	Depending on weather the beaches aren't used anyway, so why can't dog walkers enjoy them responsibly.
23	See previous comment regarding human littering.
24	If this is applied all year round then the amount of places to take your dog to exercises is beyond limited. It is unfair on those people who don't have cars but still want to care for their pet properly and ensure they get the exercise required. Having a dog is a great help with human mental wellbeing and restricting where you can take them will result in more lazy people not getting out with their animals or animals being disregarded and neglected. It is unfair.
25	Compromise.
26	I agree that the ban should be for the whole season in totality and not allow dogs in those areas during this time. Families still frequent the beach in to the evening so it would be unfair to allow dogs on there in the evening or early morning.
27	Sensible change.
28	We need to bring dog walkers into the area, so this is better than a full ban.
29	Before you actually implement this and I actually think you will you should of been monitoring the amount of people actually on the beaches at these times. I am guessing in good weather and weekend more people would use it from 12pm.
30	This would be a perfect compromise.
31	As long as fouling is enforced no need to ban at quiet times.
32	Yes that seems a much fairer option.
33	Why would the council put a time limit on the use of beaches do they not realise some people work or are not able to walk their dog at a specific time.

Appendix 1 - Do you have any comments or concerns regarding the extension of the offence relating to dogs fouling on land, and, the requirements of anyone in control of a dog/s to pick up the poo and put it in a bin?

	Please provide comments - Please provide any comments/reasons below.
34	Many dog owners (myself included) take our dogs to the beach at 8am to avoid crowds and other people and let the dogs run properly and happily. I don't want big crowds while my dogs run with their friends any more than these crowds don't want dogs on the beach during the day.
35	That is a good solution so that everyone should be allowed to enjoy the space all the time.
36	See answer above! When the council start to fine and patrol the beaches to ban uncaring people then I will agree with this.
37	Some owners will always allow their dogs to foul and leave it. Also see above regarding disturbance to wildlife.
38	Some lazy folk don't poop scoop.
39	It should be permanent all year round.
40	Remove the ban or monitor the beaches first I think the busy human times is usually 12-4/6.
41	Allows people to walk dogs early and at night. This would be a good time to be monitored too to ensure people are picking up dog poo.
42	Ok with the two bathing beaches but can't see the logic with 10.00-2000.
43	Plenty of other areas to walk a dog. Some areas should always be kept safe and dog free.
44	As long as people are picking up their poo. Most people have left the beach by then.
45	I support the ban during the summer months. There is a risk of dog fouling if the beaches are open to dogs early in the morning before people start to use them for recreational and bathing purposes.
46	This partly contradicts my above comment however I know that myself and many other dog owners do walk our dogs either early morning or later evening which is outside these times as these are safer times to walk your dog in summer. I think this would encourage owners to wait until later on to walk their dogs which would be helpful for the dogs health.
47	This seems reasonable to me.
48	It should be scrapped altogether.
49	Again beach only being used by dog walkers and horse riders.

Appendix 1 - Do you have any comments or concerns regarding the extension of the offence relating to dogs fouling on land, and, the requirements of anyone in control of a dog/s to pick up the poo and put it in a bin?

	Please provide comments - Please provide any comments/reasons below.
50	As long as dog walkers pick up dog poo I think they could be allowed to use the bathing beaches before 10 and after 20.00 in the summer. Non dog walkers tend to use the beach between 10 and 20.00 and I think it is reasonable to make it dog free at these times in the summer months as long as we have other safe dog walking areas available all year round at all times.
51	There's confusion with the public and visitors, keeping it the same all the time would stop this.
52	I agree that a time restriction during the ban - if it actually needs to be in place at all however 10am till 6pm seems more reasonable and is adopted by other councils down south.
53	I walk my dogs on the beach most days, I have no problem in not walking them on the small portion of the beach where they are not allowed. Some people do not like dogs and there should be an area where they can go and use the beaches without fear of being molested by dogs, any responsible dog owner should agree with this - being a "responsible dog owner" is more than just picking up your dog's poo, it is also about good interaction with other people.
54	Whilst I don't necessarily agree with this beach ban - hardly anyone uses the beaches to sit on these days, it is probably reasonable just in case people do.
55	No point.
56	I would be happy for the ban to be extended to early in the year to include spring time/Easter holidays. I.E beginning/mid March. Most people walking their dogs early in the morning (pre 10am) are responsible dog walkers who pick up after them and have their animals under control.
57	The timing makes no difference. Dog excrement is a pollutant that is not time restricted.
58	It shouldn't apply at any time as most dogs and owners are more responsible than gangs of teenagers and some day trippers who leave litter everywhere.
59	It shouldn't apply at any time as most dogs and owners are more responsible than gangs of teenagers and some day trippers who leave litter everywhere.
60	Most dog walkers/owners take their dogs before and after work which would work well with these timings.
61	This seems the most reasonable compromise. I would support this but think the timings should be 10.00 - 1800 as most holidaymakers go for their evening meal after 6pm and it would still give dog owners a chance to go after 6pm for an evening stroll in decent weather. I personally would not want to go after 8pm as I would not feel safe with the type of people often around at that time. I would go at 6-7pm though.

Appendix 1 - Do you have any comments or concerns regarding the extension of the offence relating to dogs fouling on land, and, the requirements of anyone in control of a dog/s to pick up the poo and put it in a bin?

	Please provide comments - Please provide any comments/reasons below.
62	No need for out of season restrictions at all.
63	It should be an all year ban.
64	If dogs must be banned in this period allowing early/late use us better than nothing.
65	In my opinion the beach is big enough for all to enjoy. Some people use beach all year round anyway and not seen them punished in any way this year.
66	At least we then get a chance to use it.
67	This is a good idea. Many early morning dog walkers have to walk past the beach to take their dog past the ban zone. People without dogs don't generally tend to be on the beach that early...
68	Just leave the ban in place during that period so people don't confuse it.
69	There are few if any families on the beach earlier or later, it's called getting ready to go out in the morning and eating sleeping in the evening.
70	Too confusing - simply keep to dates.
71	As most families are off the beach by 17:00, I think the dog ban should be between 10:00 and 18:00 only.
72	Can understand that.
73	Again the same as my above comment. It is vital dogs receive proper care and exercise. This involves having open spaces in order for them to run and play.
74	Because children use these beaches.
75	Many dog walkers exercise their dogs early and late.
76	No limitation. It's no use turning up to use the Marine Beach only to find the early morning dog turds. Better enforcement, more fines please. Keep our public areas clean!
77	It should stay as it is. People know the rules. Why change them?
78	People who want to walk their dogs on the beach can easily do so early mornings or early evenings.
79	I think that it should run from 1st April to 30th October.
80	Permanent ban.
81	Yes, this would be helpful, especially as would be a rarity to see dog wardens out at those times of the day it would be welcomed by those that live towards the far end of the beach, Please make it more obvious who the authorised officers are with some form of visibility.

Appendix 1 - Do you have any comments or concerns regarding the extension of the offence relating to dogs fouling on land, and, the requirements of anyone in control of a dog/s to pick up the poo and put it in a bin?

	Please provide comments - Please provide any comments/reasons below.
82	This would allow dogs to be walked when it is cooler.
83	Better just have a ban in this time period.
84	It works...why change.
85	No. Dogs I can be walked on the numerous grass areas we have.
86	There is no guarantee that dog mess would be washed away overnight. Due to covid-19 I have begun taking my children out earlier in the day so that we meet fewer people, typically this means we leave the house at 8am and so this change would have negative impact for us.
87	In winter there is nobody on the beaches apart from dog walkers. Why shouldn't dog owners use all the space to exercise their dogs without causing any problems to anyone when there are already so little places we can go? Even in the summer months dogs should be allowed on the beach but kept on the lead. This would bring in a lot more families to the area that own dogs and therefore bring in a lot more income because at the moment families with dogs stay away because of the restrictions. I wish Wyre could be more like Cornwall and Cumbria where dogs are allowed in more areas under control because it would create a lot more revenue for the area and allow people to enjoy the coastline that we have. Of course target those that break the rules but please don't target everyone. Humans leave a lot more mess on the beaches and the nature reserve than any dog walker I have ever known.
88	How about until 6.30PM? In Jersey they allow dogs on beaches all year round (and I have to say the beaches are far nicer and cleaner than ours). Between the hours of 1.30-18.30 they are allowed on leads only. As a holiday maker there several times this is great. Means we can sit on the beach with our family (yes I have two small children) and our family pets. I'd walk them prior to 10.30 and let them have a good run. This could work here too. Let's face it, it's not the dogs that make the mess! Its irresponsible humans who don't pick up after them. I walked my dogs during lockdown and noticed how clean the sea and beaches were. As soon as it was lifted, the beaches are left littered with rubbish, bbq left overs, cans, bottles....
89	Either all or nothing.
90	Dependent upon the tide bathers could be using the beach at the early morning and later evening times especially as this is a quieter time.

Appendix 1 - Do you have any comments or concerns regarding the extension of the offence relating to dogs fouling on land, and, the requirements of anyone in control of a dog/s to pick up the poo and put it in a bin?

A8

	Please detail your concerns below - Please detail any comments/concerns below.
1.	Limit should be reduced to 2. Try facing 8 Jack Russell terriers whilst out walking and think of a suitable riposte to the dog owners comment that " it's OK they won't bite!
2.	How many dogs is each person restricted too?
3.	There should definitely be a limit as to how many dogs people can take on, for safety and control purposes.
4.	I agree with this for the safety of other dogs, owners and families.
5.	The order should just have dogs under control. Five well behaved dogs are still safer than one dog being walked that perhaps one dog that isn't as well behaved.
6.	This doesn't seem to make much sense. There should be far more specific dog exceeding areas in the district and dog loos put into parks and other high use areas.
7.	Some 'professional' dog walkers in the Wyre area tend to congregate, leading to many dogs running off lead at any one time. These are not all 'under control' at all. At the Nature Park they are often in the water with no regard to breeding birds at all, or the ground nesting birds. Can areas be fences off at all to let dogs run in a more 'secure' area. Do the council not have land that professional walkers could hire at certain times, so long as they fulfil certain criteria?
8.	I think the 4 dog per person should be extended to cover the entire borough. As a professional walker and trainer I only ever walk 4 dogs together as its better for the dogs and much nicer for the public. The public often comment and state they wished all dog walkers would limit numbers to 4. I, myself own 5 dogs and only walk them all together when on my private land that is secure and off limits to the public or out in public when myself and partner are together so its 5 between the 2 of us. I live in the Ribble Valley where the 4 dog rule applies everywhere and it works brilliantly. I work as a walker across Wyre and have experienced dog walkers out with packs of dogs.
9.	I can control my five better than most people control their one. All the incidents I see are from someone having just one dog charging around the place.
10	If people follow rules and guidelines and can control the dogs in their care don't see it being an issue. I see people with several dogs which are better behaved than single dogs.
11	My dog has a walker and I feel that if you limit the dogs to 4, she will lose much of her business. The dogs are very we behaved together and are all small.
12	Too restricted, as someone who takes part in dog sports, I know numerous households with many dogs.

Appendix 1 - Do you have any comments or concerns regarding the extension of the offence relating to dogs fouling on land, and, the requirements of anyone in control of a dog/s to pick up the poo and put it in a bin?

	Please detail your concerns below - Please detail any comments/concerns below.
13	Caution must be excised here. It has the potential to limit the earnings and capacity for dog walkers to use the area. These people are mostly self-employed and have already suffered a significant loss due to the current pandemic. Assuming they are responsible and have the dogs under control, the limit could be extended. There also needs to be some clarity: could two walkers exercise 8 dogs, for example?
14	It should be restricted to no more than two dogs. It must be very difficult to control more and indeed more importantly to clean up after them.
15	Several people own multiple dogs others are earning a living walking dogs and supplying a necessary service which has been invaluable to many especially under Covid restrictions the shielded vulnerable and not forgetting the key workers.
16	Multiple dog owners are usually more experienced and have better control of their dogs. I know people in the dog sports community who very easily walk 10 at once. Numbers are not a way to improve responsible dog ownership. Plus people who already have multiple dogs might physically not be able to split walks, the extra time required might be an issue and you then risk issues with those dogs left behind.
17	As already stated dog owners seem to allow their dogs free reign and if they don't stay together then they can't possibly watch to see where they are fouling.
18	4 should be max per person to accommodate dog walkers.
19	Nobody can control more than 4 dogs whether they are yours or you are a dog walker and I agree with that rule.
20	It would seem to me a question more of what type, size and nature of the dogs. As well as the attitude of the person escorting the dogs, this last point being the most important.
21	My dog walker does an amazing job with all of the dogs in her care. With these restrictions put into place, her business would be put in jeopardy (at a time when people are struggling financially and we should be doing everything possible to support small businesses). Without a dog walker, my dogs would be alone in the house for hours on end whilst I go to work, again is neglectful and unfair- if you put this into place, it will hugely impact on dogs like my own being cared for by dog walkers.
22	I know many people who have multiple dogs who cannot take multiple trips to exercise their dogs. Plus it may cause distress for some to be left alone in this circumstance. It would also affect dog walker and their business.
23	We have a dog walker and it would not be fair on her to impose these restrictions we should be helping these small business.
24	I have 5 dogs. Where am I supposed to exercise them if they are banned from everywhere? People make the mess and litter everywhere not dogs.

Appendix 1 - Do you have any comments or concerns regarding the extension of the offence relating to dogs fouling on land, and, the requirements of anyone in control of a dog/s to pick up the poo and put it in a bin?

	Please detail your concerns below - Please detail any comments/concerns below.
25	The number of dogs someone has doesn't appear to correlate with their ability to control their animals.
26	No more than two dogs, both on leads in any public area.
27	A person has to be able to be in control of dogs in a public place or we have potentially hazardous scenarios. If a dog decides to lurch and is a member of a large "pack" of dogs, albeit on leads, one person may be unable to control the situation.
28	Dog walkers are a big nuisance & get around the 4 dog rule by taking a friend with them. I've often seen more than 10 dogs running around out of control with ropes tied to their collars. When the dog walker has to chase after one dog, the others are out of control. Dog walkers should not let dogs run free in public places. I have an assistance dog & he's been bothered lots of times, even attacked by dogs not controlled by their professional walkers. It stops me going to places they frequent.
29	This is lots of people business and also what if someone owns more than this? Two trips? No.
30	Yes I actually think you can only safely manage to walk 2 dogs per person.
31	The number of dogs is not an indicator of responsibility, multi dog homes are more likely to be engaged with training or dog activities. Other orders already cover dogs out of control.
32	Someone with five small dogs who are gentle and cause no problems regularly walks them at Fleetwood nature reserve. They would be unfairly adversely affected when a single dog can cause issues. The fact that there is a plan to require dogs to be put on lead if requested is in itself enough.
33	No more than 4 dogs with one person is reasonable.
34	Four each is too many. Maximum should be two.
35	I know a responsible dog owner who has five small dogs they are well behaved, why should they be penalised because one or two irresponsible dog owners who don't have control of one dog.
36	If you have more than one dog then you know your dogs and they know you! What is the difference between one person with four dogs behaving and having a nice time and someone having 5 children out of control leaving litter everywhere and making so much noise it's making everyone around them unhappy are you going to tell them they can only have 2 children with them? I think not. My dog is my child and is better behaved than most children and adults I know.

Appendix 1 - Do you have any comments or concerns regarding the extension of the offence relating to dogs fouling on land, and, the requirements of anyone in control of a dog/s to pick up the poo and put it in a bin?

	Please detail your concerns below - Please detail any comments/concerns below.
37	I do think professional dog owners now come in pairs so that they are allowed to exercise 8 dogs in total and I do feel this is inappropriate. Maybe restrict this to no more than 4 dogs per group!
38	Have you noticed that the no dog signs are always vandalised and that one person cannot control so many dogs that they are unfamiliar with.
39	I think in terms of controlling dogs on the beach, a maximum of two dogs free of the lead, but if dogs are on a lead with owners then three dogs.
40	There should be a restriction. Dogs can be very dangerous.
41	There should be no more than 4 dogs per person. Sometimes I feel that 4 is too many. Personally I don't think one person can fully supervise more than two dogs at a time.
42	Should be reduced to three.
43	I think that 2 dogs should be the limit. My dog was recently attacked nearby my home (Wyre Council were a brilliant help) and the owner had 2 dogs on leads and 1 dog off the lead which attacked my dog. He was unable to grasp the lead on the third dog due to not having enough hands. I feel that this situation may have been slightly different should there have only been 2 dogs. Dogs can pull a lot and even the strength of 1 dog is enough to be uncontrolled by an adult during a stressful incident.
44	I think it is a reasonable restriction. One person with 4 dogs already sounds hard work.
45	Providing the person is in control of their dogs then the number is not an issue. Stop playing big brother and trust people to act responsibly.
46	I understand some professional dog walkers do exercise more than 4 dogs at a time and are more than capable of controlling their charges. Maybe ask them to obtain a licence to exercise 4 or more with some sort of test to show they are proficient. That said, some members of the public own more than 4 dogs as pets and would ideally like to exercise them all at the same time. At the end of the day it only take one rogue dog to cause trouble to not sure what the rationale behind 4 comes from.
47	Should be limited to 3 dogs.
48	I think 4 dogs is too many. I have watched walkers with 4, and very often they can't watch them all properly or talking to other walkers and the dogs are fouling unnoticed.
49	Should be limited to how many can be exercised as they can not safely be controlled.

Appendix 1 - Do you have any comments or concerns regarding the extension of the offence relating to dogs fouling on land, and, the requirements of anyone in control of a dog/s to pick up the poo and put it in a bin?

	Please detail your concerns below - Please detail any comments/concerns below.
50	In the main I think a maximum of 4 is fine. However there are some dog walkers who have excellent control over 5 or 6 small dogs and some who don't. Perhaps individuals could apply for a licence to take out more and if they can justify how they will keep control and pick up poo then in exceptional cases this might be granted.
51	No one can control 6 dogs at a time or manage to pick up that amount of excrement whilst holding onto all those animals. No one should be walking more than 2 dogs.
52	I would like to know what the statistics are in terms of the reported incidents involving groups of dogs as a pose to individual dogs. As a professional dog walker, we are often frowned upon for having a group of dogs however I can honestly say that in my 3 years of walking dogs my groups of dogs have never once caused an issue. For me, the issue lies with individual dog owners who have no control over their dogs or have no recall. The nature reserve I believe is saturated currently due to the fact that it is the only place in Wyre where more than 4 dogs can be walked. There are many pet dog owners who have multi dog households and this places a huge restriction on them being able to exercise their dogs together. When out walking, my groups of dogs are not a 'pack,' they do not hold this mentality, they are not wolves in the wild. They are a group of dogs who have become friends and will happily play with other dogs. I believe the wider issue relates to laws that are already in place, that are not adhered to, this being that dogs should be under control at all times. I appreciate that the question is asked as to how can 1 person control 6 dogs. My answer to that is training. All of my dogs will return to me on the cue of just 1 word and this is because they have been trained. I don't believe there is a need for a further restriction on the amount of dogs that can be walked by one person as there is already a clear law in place that all dogs must be kept under control at all times. I believe that it would be far more beneficial to have measures in place to address the issue of dogs who are not under control by way of fines, anti social behaviour orders and requirements to undertake relevant training with the dogs to address the specific issue rather than penalising those who are responsible. The majority of issues I have encountered have related to individual dog owners, those who's dogs have no recall and will approach any dog despite them being on lead, those who allow aggressive dogs off lead and have no regard for the safety of others. I genuinely believe that by easing the restrictions of the number of dogs walked, that this will enable the nature reserve to become less saturated and by imposing appropriate orders on irresponsible dog owners the real issues will be addressed. The majority of other local councils do not feel the need for a 4 dog limit and this has been successfully managed.
53	Should be less "professional" dog walkers often exercise in groups larger than are allowed at the moment, they are sometimes not familiar with the animals they are with the dogs are often not properly in control and it is difficult for the walkers to see a) where all the dogs are pooing b) pick up said poo whilst trying to control several dogs. The result is that poo gets left, giving dog owners a bad name.

Appendix 1 - Do you have any comments or concerns regarding the extension of the offence relating to dogs fouling on land, and, the requirements of anyone in control of a dog/s to pick up the poo and put it in a bin?

	Please detail your concerns below - Please detail any comments/concerns below.
54	I have 9 dogs and have had that number since before this came into effect. They are my own pet dogs and I make sure I always pick up after them. If I meet anyone on a walk I keep out of their way or put them on the lead if I cannot get off the path and I do not let them off anywhere where they are not meant to be. There are few enough places anyway to let dogs off the lead in the local area any now you are proposing to restrict them further. I was hoping this would not be extended so I can start walking my dogs together. I understand not allowing dog walkers to not walk large groups of dogs but it does penalise people who have a large number of pet dogs as well. I have my dogs as I do sports with them as my hobby so it is a pain to have to do 3 walks when I could do 1.
55	Should only be applied to 'commercial' dog walkers.
56	Nobody can safely have charge of several dogs! How on earth can you pick up dog mess while holding on to several dogs!
57	Most of these dog walkers are insured to walk 6 dogs per person why impose more restrictions, if these are made to lower this they will have to have more people working with them which I would imagine most can't afford to pay others.
58	I feel the majority of concern about dogs' behaviour using stems from dog walkers having too many dogs off the lead at the same time.
59	I feel person should be able to exercise as many dogs as they can control. Dog wardens are there to ensure that dogs are under control and may sanction people who are unable to manage their dogs.
60	One person 4 dogs seems reasonable although I know some able bodied people would be quite capable of handling more. My concerns are around commercial dog walkers with vans who often have 8 or 9 dogs. I have seen at Fleetwood Marsh a Blackpool dog walking van with 9 dogs managed only by one adult and one child! When 9 dogs come at my two and me on my walking stick it can be intimidating even if they are being friendly. If they are not friendly and one person is trying to control them it is a nightmare.
61	Dog walking companies often have multiple dogs and I have never seen that as a problem.
62	Never seen more than 4 dogs being walked....and I am in my 60s!!!!
63	I feel that three dogs per person any more you are in the realm of a pack, also only if they are all opened by that person. I have a few run-ins with a dog walker in Fleetwood who walks a number of dogs with not a lot of control, ALL OFF LEAD and when asked to put them on lead because they are attacking my dog she becomes very aggressive and abusive. So much so that I no longer go to Jamison Road because of her.
64	I don't believe that ANYONE should walk more than 4 dogs at once. And that professional dog walkers should only walk on private land as they do not know the dogs they are walking well enough.

Appendix 1 - Do you have any comments or concerns regarding the extension of the offence relating to dogs fouling on land, and, the requirements of anyone in control of a dog/s to pick up the poo and put it in a bin?

	Please detail your concerns below - Please detail any comments/concerns below.
65	I intend to have 2/3 dogs which is manageable, I have encountered dog walkers with excess of 8 dogs which I found intimidating and could be dangerous for families/young children.
66	I feel the council is discriminating against dog owners. If the council wishes to regulate professional dog walkers, something I wholeheartedly agree with, then this is not the way to do this.
67	Given people are walking more, a reduction in the number of dogs should be applied. Also, the number of dogs in one party. I came across 4 people with 13 dogs walking on a pavement. 3 dogs per person, 2 dogs per person in party size 2 or more.
68	I think 4 is too many for one person.
69	4 is very strict compared to other places I must admit. Professional Dog walkers have a business to run, or please provide an area for them?
70	Reduce the number from 4 to 2.
71	I think that a maximum of two dogs per person is quite enough.
72	Maximum of 2 dogs per person.
73	Can any person other than those trained to do so really keep more than two dogs under proper safe control? I feel this would be very unusual even considering a mixture of dogs on and off leads so that no more than two are off at any one time.
74	I think 2 dogs per person is adequate. The problems arise when businesses looking after dogs take the whole lot out in large numbers.
75	It's a good idea.

Appendix 1 - Do you have any comments or concerns regarding the extension of the offence relating to dogs fouling on land, and, the requirements of anyone in control of a dog/s to pick up the poo and put it in a bin?

	Please detail your concerns below - Please detail any comments/concerns below.
76	<p>As a professional dog walker I am insured to walk six dogs at one time. From years of experience I know I can control six dogs a lot better than one person walking just one dog as I have seen many times that person is too busy on the phone or talking to someone else while their dog is running off into the distance and fouling without the owner either noticing or refusing to walk over and pick up after it. These are the people that should be given fines, especially the weekend walkers. The head ranger from Lancashire county council has seen me at Fleetwood nature reserve several times in charge of six dogs and every time they have been under control and I have picked up after each and every one of them. This is very easy to do because they are kept under control. When one dog fouls I'll pick up and allow it off the lead and so on until all six are off lead - you know your dogs and which ones, first so to say it's impossible to pick up after 6 simply isn't true. I have offered for a council member to join me on a walk to see exactly how this is done and how under control the dogs are. If insurance companies deem it safe for one person to walk six dogs how can a council or one man decide it isn't? Many of the dogs I walk belong to elderly or disabled people who physically cannot walk their dogs. If this new rule of four dogs is brought in there is a very strong possibility that I may have to close my business because there isn't enough hours in the day to fit in another walk. The thought of having to tell my clients that I cannot walk their dog anymore after years of doing so it's unthinkable. If this were to happen then more people would start opening up dog walking business thinking it's an easy job which it isn't and as I have witnessed especially since lockdown these people are not insured so any dog fights or accidents that may happen on the walks will not be covered. Also there are people who own five dogs who have limited mobility and simply cannot do more than one walk a day. How are they meant to manage walking their dogs if they cannot take them all together? If dogs are left at home this will create psychological problems for the dogs and could lead to lots of rehoming and depression in owners. Blackpool Council tried to introduce a four dog max rule in 2018. After discussions with them and letters from vets and other animal agencies regarding a dog's health and well being if walks were taken away from them plus the benefits of owning a dog to people already suffering with issues they saw fit to not introduce the rule. I hope Wyre and Lancashire Council can see the issues raised and decide against it too.</p>
77	Not really - 4 is enough for anyone.
78	Either all or nothing.
79	Dependent upon the tide bathers could be using the beach at the early morning and later evening times especially as this is a quieter time.

Appendix 1 - Do you have any comments or concerns regarding the extension of the offence relating to dogs fouling on land, and, the requirements of anyone in control of a dog/s to pick up the poo and put it in a bin?

A9

	Please detail your concerns below - Please detail your concerns below.
1.	There needs to be an authorised person or persons monitoring dog fouling as there seems to be a huge problem with people not picking up after their animals.
2.	All responsible dog owners should never walk their dog without poop bags! Simple.
3.	What if I go out with my dogs and pick up after them but then lose my bags or run out and one of them had eaten a dodgy burger and gets caught short? Instead of going out with fines go out with poo bags!
4.	It might be a case where by a dog owner has just exhausted his supply of soil bags and is making their way home, to replenish supplies, for another walk.
5.	Yes as sometimes it would appear unfair if you had just used your last bag for disposal. If you can demonstrate that you have done this (by showing the empty roll in the holder) then it should be accepted that you are not irresponsible. I appreciate however, this could always be open to abuse.
6.	There is an increasing incidence of dog fouling around our area, sadly a minority but increasing number, of owners choose not to pick up.
7.	Although you come out with enough bags sometimes you can be caught short.
8.	Yes as a dog owner you need to take responsibility for you actions and your dog because they cannot pick up themselves!
9.	All dog owners should carry poo bags and pick up. And the rangers should enforce it which they don't
10	Slightly - I think you should be allowed a warning before a fine.
11	I completely agree with this!! All dog owners I know have poo bags in every place possible - the car, every jacket pocket, in every bag. There has been plenty of times where my dog has been to the toilet early on in the walk and then done it another 2/3 times during a longer walk so it could always happen. This enforcement should make people think twice about packing enough poo bags when making a journey with a dog.
12	Whilst the majority of responsible dog owners carry poo bags, occasionally they might forget. The authorised officer should provide a bag.
13	Doggie bags and more bins (regularly emptied) should be supplied on all parks. Picking up should be encouraged at the time but leeway given (or a bag provided) for genuine cases. Enforcement/fines should only be applied if owner is non co-operative or abusive. Dog owners provide a (mostly) friendly atmosphere to an area and typically do not throw around beer bottles (sometimes broken), plastic bottles and sweep/sandwich wrappers on

Appendix 1 - Do you have any comments or concerns regarding the extension of the offence relating to dogs fouling on land, and, the requirements of anyone in control of a dog/s to pick up the poo and put it in a bin?

	the ground rather than a bin (and many even pick up these items after they have been disposed of by others especially when they can prove dangerous to animals and wildlife).
14	Great idea. Enforce it properly.
15	I always prefer to have several poo bags on me during walkies but once or twice, the weather, the wild wind has caught me out and ripped them from my grasp...so I hope I never get in the position to be fined and would be offended if an officer didn't believe my explanation...this situation.

Appendix 1 - Do you have any comments or concerns regarding the extension of the offence relating to dogs fouling on land, and, the requirements of anyone in control of a dog/s to pick up the poo and put it in a bin?

A10

	Please tell us why not
1.	Everything else is increasing, therefore this should too. There is absolutely no reason why somebody shouldn't be a responsible dog owner. I'm not sure what the percentage increases there have been to services and costs etc, but an increase to the fine, falling in line with other increases, cannot be argued against.
2.	It's too much.
3.	I think it should be higher as not enough people respect it.
4.	Too expensive and outside agency workers are too quick to fine innocent people.
5.	Needs to be higher and rigorously enforced.
6.	Should not be such a high figure.
7.	Raise it but let dogs have access all year round.
8.	The current rules do not appear to deter; perhaps a penalty increase (to fund additional enforcement officers?) would help.
9.	Increase it to make it punitive.
10.	Even the most well behaved dog will occasionally wander off when they see a bush or another dog they want to sniff or play with. Currently Cleveleys and Fleetwood do not offer a dog walking only park, and it is unfair to subject them to travelling out of their own postcode area and potentially paying to rent fields. The beach and nature reserve are a home to these dogs and their owners. They should not be charged £100 for a dog not knowing where this human-enforced boundary begins and ends. For them they have always been allowed to run where they like, they may not understand that this has now changed.
11.	Far too low.
12.	It should be much more as a deterrent.
13.	Should be higher. It's absolutely disgusting the amount of dog dirt left on foot paths.
14.	Not a big enough fine it does not deter a certain percentage of dog owners.
15.	Far too much might be ok in affluent Poulton but certainly not Fleetwood it's enough to cripple families.
16.	I do feel like £100 is too much, especially if it was an accident. Perhaps a strong warning/small fine for the first offence and then a larger fine for second offences and onwards.
17.	It's too much £50 is plenty.

Appendix 1 - Do you have any comments or concerns regarding the extension of the offence relating to dogs fouling on land, and, the requirements of anyone in control of a dog/s to pick up the poo and put it in a bin?

	Please tell us why not
18.	Think it should be 10 pounds people are struggling for money these days
19.	I agree to the fixed penalty but the officers should ask people first. Lots of comments by people that they are followed by the company you use, that they deceive people and they should also be asked to pick up poo or rubbish before being fined. Aggressive and threatening behaviour from these individuals isn't acceptable.
20.	Too high. Should be reduced.
21.	Increase the fine and enforce it.
22.	It should be increased and more officers about to enforce the penalty. The footpaths around Trunnah road, Lawsons Road, Stanah are all covered in dog faeces.
23.	Should be much higher.
24.	If dog owners are given a fixed penalty then so should those who choose to exercise their horses on the beach and anywhere. It's still pop and needs to be picked up.
25.	I feel it should be reduced to an affordable amount. The fixed penalty should be to deter and not as a revenue stream
26.	For persistent offenders yes but not for an oversight.
27.	It's too expensive. I think £75 is still a deterrent the main thing is that officers enforce it.
28.	First warning should be given. Names taken letter sent.
29.	The fine should be higher ie £500
30.	If as I stated earlier these changes are not sufficiently communicated and there are no notices up at the nature reserve for instance, people could come out owing several hundred pounds in fines through no fault of their own. Owning a dog is not cheap anyway with food, vets and insurance. People are used to bringing their dogs so just putting up a notice on the board would not be sufficient. There needs to be large notices throughout advising these changes so that people cannot miss them.
31.	Again a licence to print money...people can make mistakes...let's be tolerant and live and let live. Obviously for serial offenders yes.
32.	I believe £25 would be fairer unless again recipient was being offensive. If non-pick up was evident within a 30 minute window then further fines could be legislated.
33.	I hope your officers have enough common sense to judge who is a genuine poo bag carrying dog owner compared to the few who don't give a damn...
34.	Think it should be higher.

Appendix 1 - Do you have any comments or concerns regarding the extension of the offence relating to dogs fouling on land, and, the requirements of anyone in control of a dog/s to pick up the poo and put it in a bin?

	Please tell us why not
35.	Too high. Again as a regular dog walker who does clean up after my two I am saddened by the amount of dog mess left on the beaches, paths etc. The enforcement officers need to go out first thing in the morning/last thing evening. Since they have started I think I have only ever seem then 2/3 times! Once in Fleetwood Park and once at the Sunken Car park.
36.	Excessive amount. Should be a warning first and then increase for re-offenses.
37.	It should be higher to take into account the costs of managing the orders and to encourage owners to take the penalty seriously.



Dog control – Wyre Public spaces Protection Order consultation 2020

1. First please tell us if: *(please select one answer only)*

- You currently own or care for a dog
- You operate a business, care for/walk other people's dogs. You might also own dogs
- You have recently owned or cared for a dog (in the past year)
- You have previously owned or cared for a dog at some point
- You have never owned or cared for a dog

2. If you currently own a dog/s, how many do you own?

For more details on each element of the Order, you can view the [Public Space Protection Orders](#) (PSPO's) on the council website or you can request a copy via 01253 891000 if there isn't one included with this questionnaire

3 Do you have any comments or concerns regarding the extension of the offence relating to **dogs fouling on land**, and, the requirements of anyone in control of a dog/s to **pick up the poo and put it in a bin**? *(please select one answer)*

Yes No

3a If you selected Yes please details your concerns below

Appendix 16 – Survey Questionnaire (hard copy, no filter rules)

4. Do you have any comments or concerns regarding the extension of the order in relation to the requirement to **put dogs on leads by direction from an authorised officer?** *(please select one answer)*

Yes

No

- 4a If you selected Yes please detail your concerns below:

5. Do you have you any comments or concerns regarding the extension of the order regarding the requirement to have **dogs on leads in certain areas?** *(please select one answer)*

Yes

No

- 5a If you selected Yes please detail your concerns below

Appendix 16 – Survey Questionnaire (hard copy, no filter rules)

Following the last round of consultation, dogs were allowed in the council cemeteries, with a requirement to be on a lead at all times.

These are not formal exercise areas, but have recently appeared to be used as such, with an increase in reports of owners not picking up after their dog, causing distress to visitors and complaints.

6. Should dogs be banned from the cemeteries? (please select one answer)

Yes

No

6a If you selected Yes please detail your concerns below

7. Do you have any comments or concerns regarding the extension of the order in relation to **dog exclusion areas**?

Yes

No

7a If you selected Yes please detail your concerns below

Appendix 16 – Survey Questionnaire (hard copy, no filter rules)

Marked sports pitches, currently fall under the exclusion, however, many of these sites are not in use all of the time. When they are not being used for organised activity, unfenced pitches are reportedly being used for exercising dogs.

The practice of other authorities is that the exclusion of dogs on unfenced marked pitches applies **only** when an organised activity is taking place.

8. **Do you agree with this proposed change? There will still be a requirement for people to pick up after their dogs and further signage will make this clear. (please select one answer)**

Yes

No

- 8 a **Please provide any comments/reasons below.**

To comment on the following two questions, please refer to the Cleveleys and Fleetwood bathing beach areas which should accompany this questionnaire.

9. **Do you think the ban on the two bathing beaches (approx 1.4km in total) should be applied all year round? (please select one answer)**

Yes

No

- 9a **Please provide any comments/reasons below.**

Appendix 16 – Survey Questionnaire (hard copy, no filter rules)

10. Do you think the ban on the two bathing beaches should remain seasonal (1 May to 30 September) but be limited to 10:00-20:00?
(please select one answer)

Yes

No

- 10a Please provide any comments/reasons below.

11. Have you any comments or concerns regarding the extension of the order that restricts the number of dogs one person can exercise at a time in certain areas? (please select one answer)

Yes

No

- 11a Please detail any comments/concerns below.

Appendix 16 – Survey Questionnaire (hard copy, no filter rules)

12. Do you have comments or concerns regarding the extension of the order, where it is an offence to not have the means to pick up after the dog under your control when asked by an authorised officer? *(please select one answer)*

Yes

No

- 12a Please detail your concerns below.

13. Do you agree with the level of the Fixed Penalty for non-compliance remaining at £100? *(please select one answer)*

Yes

No

- 13a Please tell us why not

Appendix 16 – Survey Questionnaire (hard copy, no filter rules)

Following numerous complaints of dogs out of control on Fleetwood Nature Park, Jameson Road, and due to the negative effect on wildlife, Lancashire County Council have requested the following:

14. Map 001: Proposed area for dog exclusion

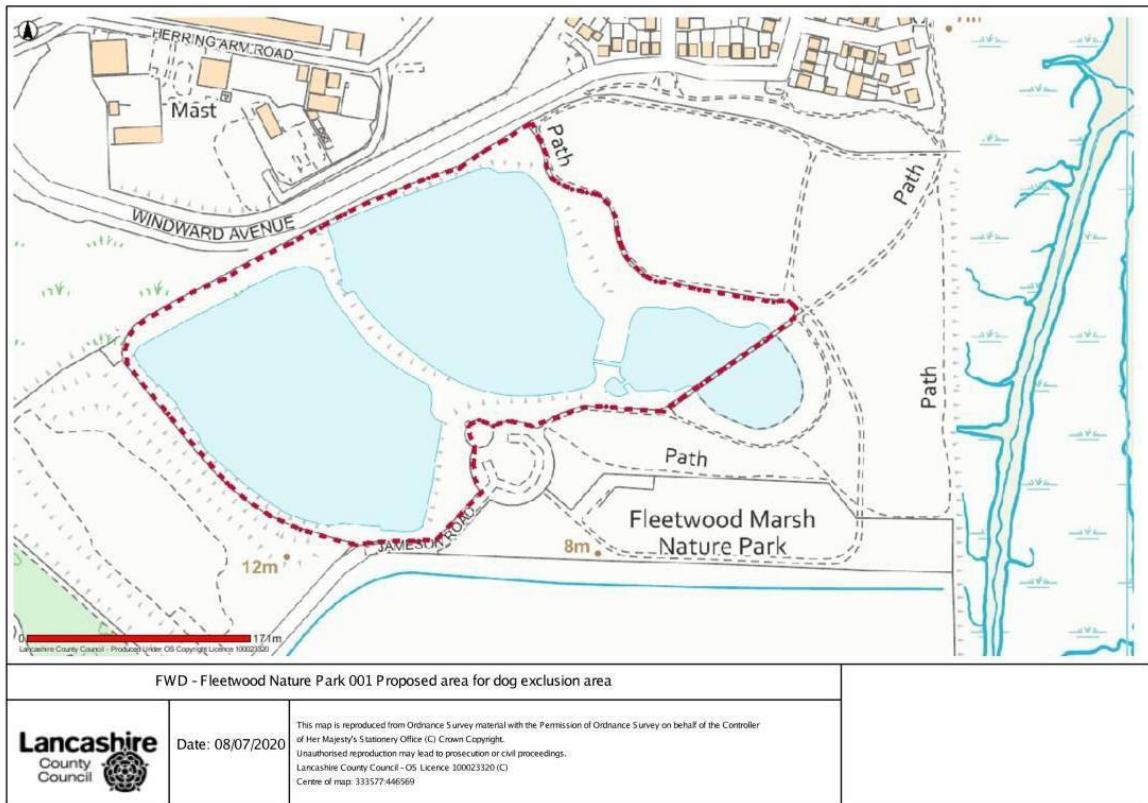

14. That dogs will be excluded from the lagoons and areas marked on the map 001 (above) at all times

b) Do you agree with the proposed dog control measure at the nature park?
(please select one answer)

Yes

No

b) Please provide comments

Appendix 16 – Survey Questionnaire (hard copy, no filter rules)

15. **Map 002: Proposed area for dog on lead at all**

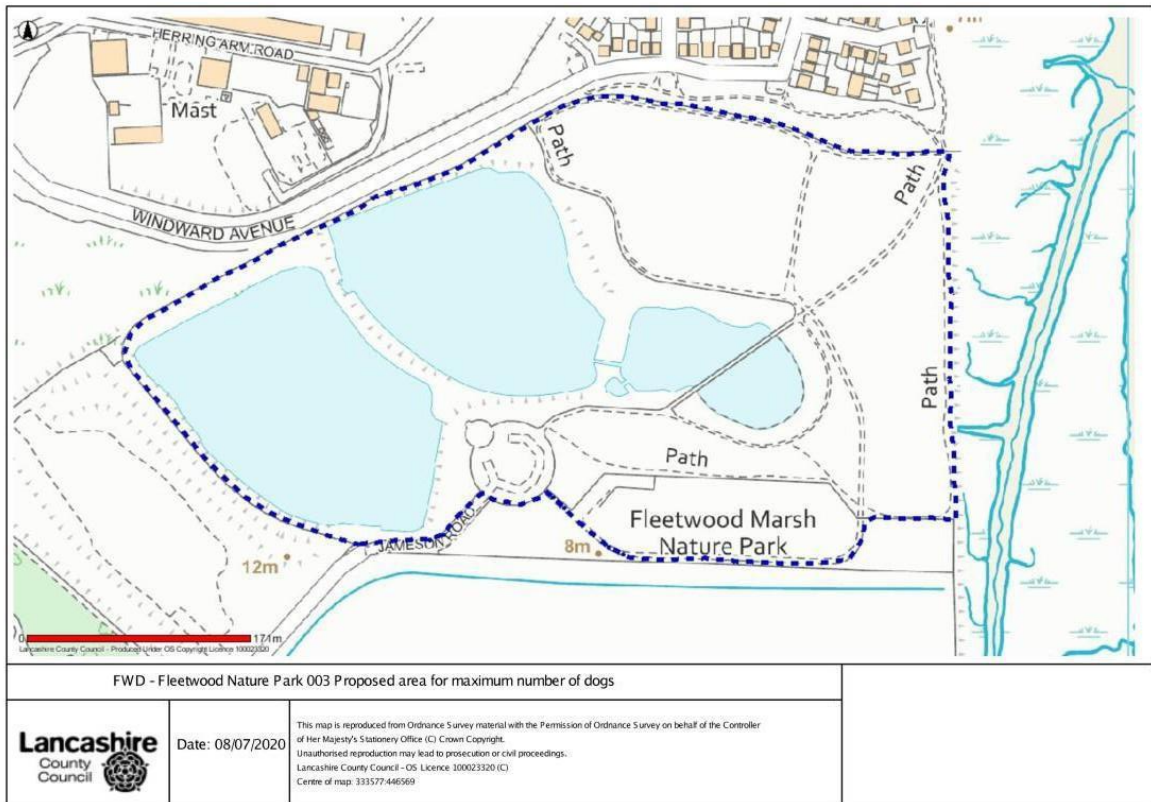

15. That dogs must be on a lead in certain areas (see Map 002 above).

a) **Do you agree with the proposed dog control measure at the nature park?**
(please select one answer)

Yes

No

b) **Please provide comments**

Appendix 16 – Survey Questionnaire (hard copy, no filter rules)

16. **Map 003: Proposed area for maximum number of**

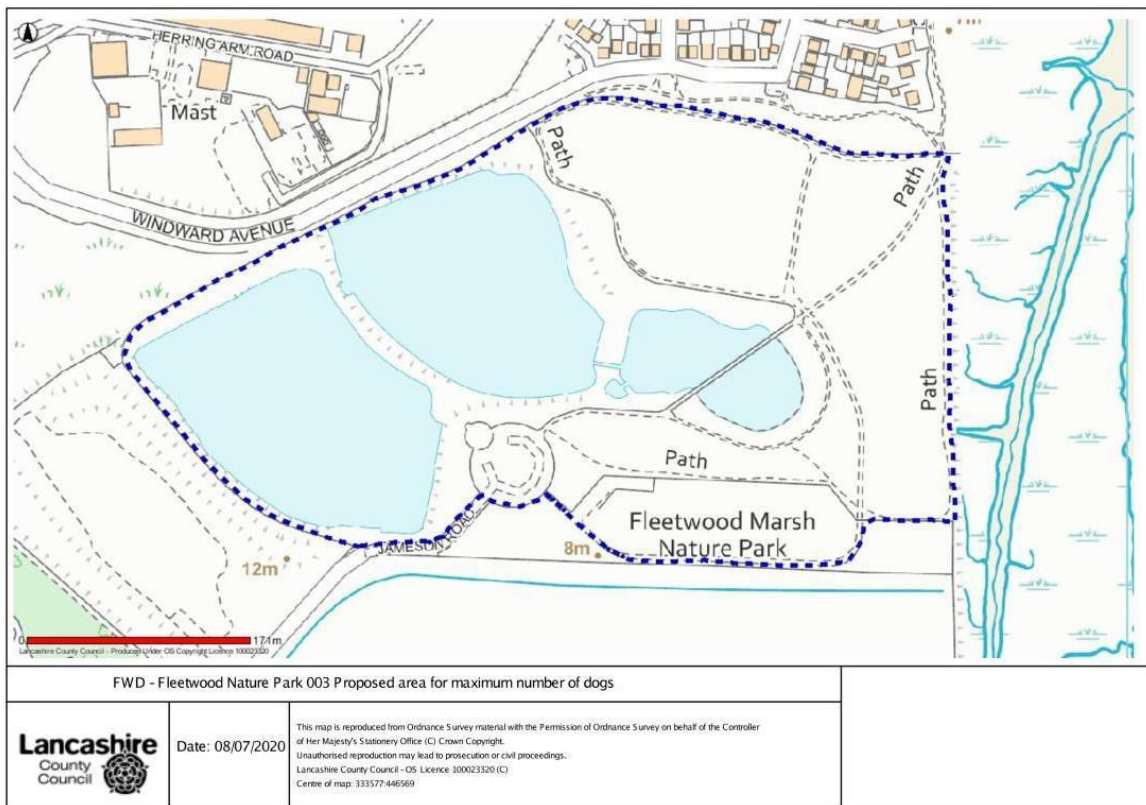

16. That a maximum of 4 dogs be walked / under the control of one person is applied across the whole site (see Map 003 above).

(a) Do you agree with the proposed dog control measure at the nature park?
(please select one answer)

Yes

No

(b) Please provide comments

Appendix 16 – Survey Questionnaire (hard copy, no filter rules)

17. **Map 004/005: Proposed area for failure to pick up dog faeces and proposed area for means for pick up**

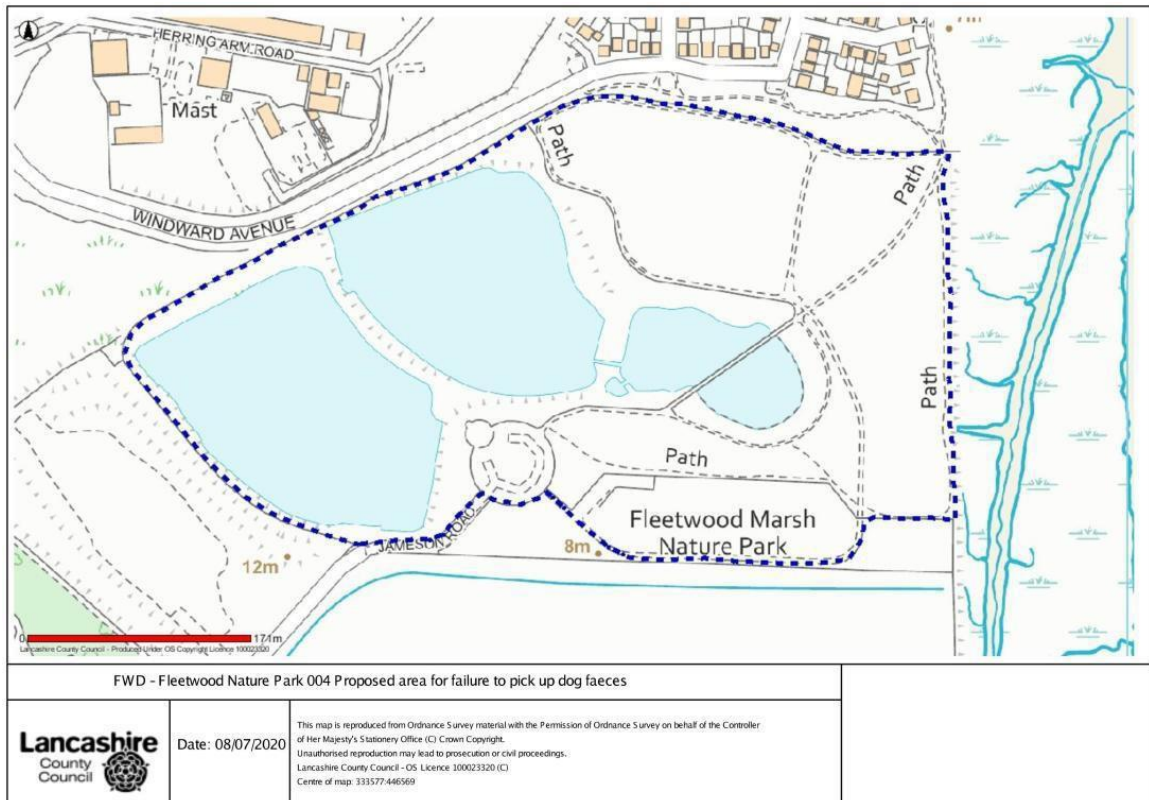

17. That there will be a requirement to pick up dog foul, and have the means to pick foul across that whole site (map 004 /005 above).

a) Do you agree with the proposed dog control measures at the nature park? (please select one answer)

Yes

No

a) Please provide comments

Appendix 16 – Survey Questionnaire (hard copy, no filter rules)

18. **Map 006: Proposed area for dogs on a lead at the request of an authorised officer**

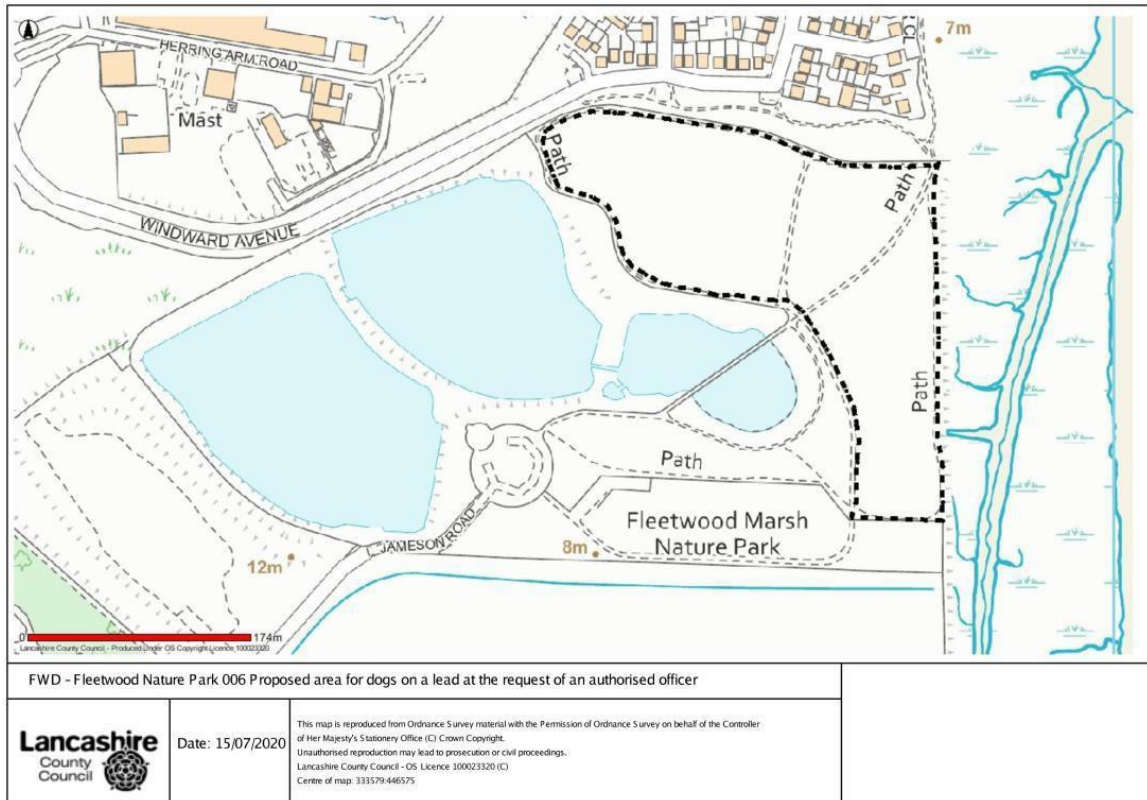

19. That an authorised officer can instruct a dog to be put on a lead (see Map 006 above).

a) **Do you agree with the proposed dog control measure at the nature park?**
(please select one answer)

Yes

No

b) **Please provide comments**

Appendix 16 – Survey Questionnaire (hard copy, no filter rules)

About you

To make sure we better understand the views of people using council services in Wyre, we would like to know a few details about you. This will help us know whether concerns and priorities differ between different groups of people.

Please note this information will only be used for statistical purposes to see how views differ. No information will be released that would allow the identification of any individual

This question must be completed.

Have you completed this questionnaire on behalf of: (*please select one answer*)

A community group.

A parish / town council

Yourself

A business

Other

Other: please say who you have responded on behalf of

Please tell us your postcode. This will help us to identify which areas of the borough are having the most issues.

If you are happy for us to contact you in future, please enter the rest of your contact details below.

Your name

Contact number

Contact email

Appendix 16 – Survey Questionnaire (hard copy, no filter rules)

Postal address if you don't have email access.

Gender

Male

Female

Prefer not to say

Age group

16-24

25-34

35-44

45-54

55-64

65-74

75+

Do you consider yourself to have a long term illness or disability that limits your daily activities?

(please select one answer)

Yes

No

Prefer not to say

Thank you for your time.

Please return this survey to Wyre Council :

Civic Centre
Breck Road
Poulton-Le-Fylde
Lancashire
FY6 7PU

OR

Marine Hall,
The Esplanade
Fleetwood
Lancashire
FY7 6HF

OR

Garstang TIC
Unit 1, Cherestanc Sq.
Garstang
Lancashire
PR3 1EF

Appendix 16 – Survey Questionnaire (hard copy, no filter rules)

CATTERALL PARISH COUNCIL

Gillian Benson,
Clerk to the Parish Council,



07 August 2020

Ruth Hunter,
Head of Public Realm and Environmental Sustainability,
Wyre Council
Civic Centre,
Poulton

Appendix 16 – Survey Questionnaire (hard copy, no filter rules)

Appendix 16 – Survey Questionnaire (hard copy, no filter rules)

Wyre Council – 3 Year Review of Public Spaces Protection Orders - Control of Dogs and Dog Fouling

Dear Ruth,

Please refer to the attached map.

The Queen Elizabeth II Playing Field, Catterall belongs to the Parish Council, who fully support the present **Dogs must be on leads at all times** for users.

Catterall Parish Council has recently implemented a number of improvements to the playing field namely;

Wheeled Play Area,

Older Children's Play Area,

Reading / Quiet Area,

Picnic Area,

Since the previous PSPOs were confirmed.

The football pitch also needs inclusion. Local teams who hire the pitch are having to scour the pitch for dog fouling before every match to protect their young players. Indeed it needs clearing twice for the marking out and the games.

The Parish Council ask that these areas are now included in the **no dogs at any time** legislation for the protection and cleanliness of those younger visitors and parents using these areas.

The Parish Council thanks you for your assistance in this matter

Yours Sincerely,

Gillian Benson

Clerk to the Parish Council